



EXCELLENCE SINCE 1995



**VIBA FLUID CONTROL**  
Manufacturers of all types of industrial valves



## Foreward ...

An ISO 9001-2015 company, promoted by the technocrats in 1995, who were having an experience of over Four decades in valve technology. The company is engaged in Design, Development, Manufacturing and Supply of quality industrial valves. The company has the expertise and facilities to meet the growing demand of process industries for standard/customized valves for a wide range of applications.

Our wide range of products includes Cast Steel, Alloy Steel, Stainless Steel and Forged Steel Gate, Globe, Check, Ball, Butterfly, Diaphragm, Safety, Pressure Reducing, Bellow Seal, Plug, Needle Valve, Y type & Basket type strainers, etc., from sizes ranging from 15NB to 600 NB in Pressure Rating from 150# to 2500#, PN6 to PN160, ND40 & ND64 as per API, ANSI, ASME, BS and DIN standard. The Valves can be supplied with Electric Actuators/ Pneumatic Actuators/ Gear Operated. Butt Welded Ends, Stellite & Monel Seat & Disc, and Extended Spindle as per customer's specifications. In house facility of stelliteing is available. We also have IBR approval for all the valves.

We have been supplying these valves to various core sectors like Petrochemicals, Thermal, Power Plant, Fertilizers, Refineries, Shipping and other Chemical Units both in the domestic as well as international market with Third Party Inspection like Lloyds, BV, SGS, TUV & MOODY.

The Company adheres to the applicable international standards of manufacturing and testing. Each department is headed by technically qualified and experienced people in the field of valve industry. We procure best quality raw materials and castings from best foundries.

A handwritten signature in blue ink, appearing to read 'K. Suresh Kumar'.

**K. Suresh Kumar**  
Proprietor

# INDEX

PAGE NO.	DESCRIPTION
01	GATE VALVE CLASS 150
02	GATE VALVE CLASS 300
03	GATE VALVE CLASS 600
04	GATE VALVE CLASS 900/1500/2500 BOLTED BONNET
05	GATE VALVE CLASS 900/1500/2500 PRESSURE SEAL BONNET
06	GLOBE VALVE CLASS 150
07	GLOBE VALVE CLASS 300
08	GLOBE VALVE CLASS 600
09	GLOBE VALVE CLASS 900/1500/2500 BOLTED BONNET
10	GLOBE VALVE CLASS 900/1500/2500 PRESSURE SEAL BONNET
11	SWING CHECK VALVE CLASS 150
12	SWING CHECK VALVE CLASS 300
13	SWING CHECK VALVE CLASS 600
14	SWING CHECK VALVE CLASS 900/1500/2500 BOLTED COVER
15	SWING CHECK VALVE CLASS 900/1500/2500 PRESSURE SEAL
16	FLOATING BALL VALVE CLASS 150 (2/3-PIECE)
17	FLOATING BALL VALVE CLASS 300 (2/3-PIECE)
18	TRUNNION MOUNTED BALL VALVE CLASS 150/300 (2/3-PIECE)
19	TRUNNION MOUNTED BALL VALVE CLASS 600 (2/3-PIECE)
20	BALL VALVE CLASS 800
21	FORGED STEEL GATE & GLOBE VALVE CLASS 800
22	WELDED BONNET FORGED STEEL VALVE CLASS 1500/2500
23	FORGED STEEL LIFT CHECK VALVE CLASS 800/1500/2500
24	SLUICE VALVE
25	BUTTERFLY VALVE
26	DIAPHRAGM VALVE
27	WAFER TYPE CHECK VALVE SINGLE PLATE & DUAL PLATE
28	STRAINER "Y" & BASKET TYPE CLASS 150
29	FLANGE DIMENSIONS (ASME B16.5)
30	BUTT WELD END DIMENSIONS (ASME B16.25)
32	DIMENSION OF RING JOINT (ASME B16.5)
34	ASTM MATERIALS
35	PRESSURE- TEMPERATURE RATINGS (ASME B16.34)

## GATE VALVE CLASS 150 API 600

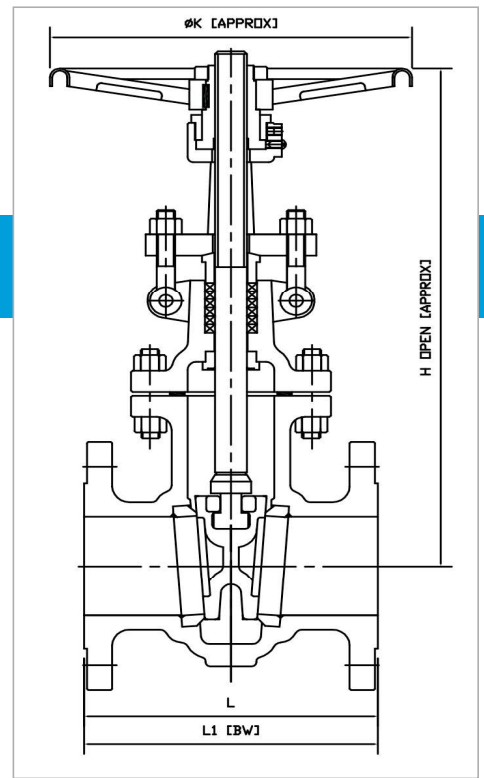

### MATERIAL SPECIFICATION

PARTS	MATERIAL		
BODY	WCB	WC6	CF8/ CF8M
BONNET	WCB	WC6	CF8/ CF8M
YOKE	WCB	WC6	CF8/ CF8M
WEDGE	13% CR	13 Cr.	CF8/ CF8M
SEAT RING	FACING ON WCB CA 15/13% FACING ON WCB	FACING ON WC6 13% Cr STEEL	SS 304/SS 316 CF8/ CF8M
BACK SEAT		SS 410	INTEGRAL
SPINDLE		SS 410	SS 304/ SS 316
GLAND BUSH		SS 410	SS 304/ SS 316
GLAND FLANGE		CARBON STEEL/WCB	SS 304
YOKE SLEEVE		ASTM A 439 Gr.D2/ AL BRONZE	
YOKE NUT		ASTM A 515-70	SS 304
HAND WHEEL		CARBON STEEL	
HAND WHEEL NUT		CARBON STEEL	SS 304
STUD & NUT	B7/2H	B16/7	B8/8
EYE BOLT & NUT		B7/2H	B8/8
CROSS BOLT & NUT		B7/2H	B8/8
GLAND PACKING		GRAFOIL	
GASKET		SPIRAL WOUND SS304/SS316	
GRUB SCREW		STEEL	
GREASE NIPPLE		BRASS/STEEL	
NAME PLATE		ALUMINIUM/SS	

\*MOC & TRIMS CAN BE SUPPLIED AS PER CUSTOMER REQUIREMENT.

### DIMENSION TABLE

VALVE SIZE	IN	2	2.5	3	4	5	6	8	10	12	14	16	18
	mm	50	65	80	100	125	150	200	250	300	350	400	450
L		7.0	7.5	8.0	9.0	10.0	10.5	11.5	13.0	14.0	15.0	16.0	17.0
		178	190	203	229	254	267	292	330	356	381	406	432
L1		8.5	9.5	11.12	12.0	15.0	15.9	16.5	18.0	19.8	22.5	24.0	26.0
		216	241	282.5	305	381	403	419	457	502	572	610	660
H app		400	445	485	600	725	765	985	1220	1395	1500	1775	2000
K app		200	200	250	250	300	300	350	450	500	559	559	610
WT. Kg app (F/E)		20	28	33	55	70	90	130	225	330	450	530	625

### DIMENSION TABLE

VALVE SIZE	IN	20	22	24	26	28	30	32	36
	mm	500	550	600	650	700	750	800	900
L		18.0	19.0	20.0	22.0	24.0	24.0	28.0	28.0
		457	483	508	559	610	610	711	711
L1		28.0	30.0	32.0	35.5	39.0	39.0	-	48.0
		711	762	813	902	991	991	-	1219
H app		2210	2530	2725	2800	3130	3300	3420	3975
K app		610	660	660	711	711	813	813	864
WT. Kg app (F/E)		825	1150	1210	1415	1620	2025	2450	3050

## GATE VALVE CLASS 300 API 600

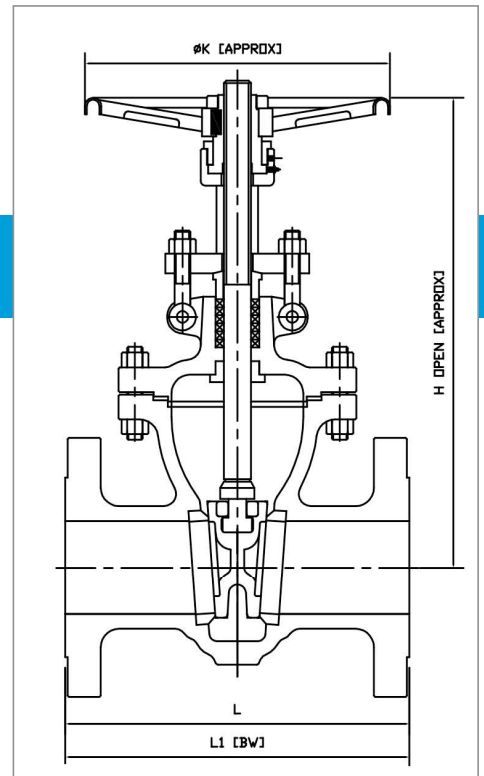

### MATERIAL SPECIFICATION

PARTS	MATERIAL		
BODY	WCB	WC6	CF8/ CF8M
BONNET	WCB	WC6	CF8/ CF8M
YOKE	WCB	WC6	CF8/ CF8M
WEDGE	13% Cr. FACING ON WCB	13 Cr. FACING ON WC6	CF8/ CF8M
SEAT RING	CA 15/13% Cr. FACING ON WCB	13% Cr. STEEL	SS 304/SS 316 CF8/ CF8M
BACK SEAT	SS 410		INTEGRAL
SPINDLE	SS 410		SS 304/ SS 316
GLAND BUSH	SS 410		SS 304/ SS 316
GLAND FLANGE	CARBON STEEL/WCB		SS 304
YOKE SLEEVE	ASTM A 439 Gr.D2/ AL BRONZE		
YOKE NUT	ASTM A 515-70		SS 304
HAND WHEEL	CARBON STEEL		
HAND WHEEL NUT	CARBON STEEL		SS 304
STUD & NUT	B7/2H	B16/7	B8/8
EYE BOLT & NUT	B7/2H		B8/8
CROSS BOLT & NUT	B7/2H		B8/8
GLAND PACKING	GRAFOIL		
GASKET	SPIRAL WOUND SS304/SS316		
GRUB SCREW	STEEL		
GREASE NIPPLE	BRASS/STEEL		
NAME PLATE	ALUMINIUM/SS		

\*MOC & TRIMS CAN BE SUPPLIED AS PER CUSTOMER REQUIREMENT.

### DIMENSION TABLE

VALVE SIZE	IN	2	2.5	3	4	5	6	8	10	12	14	16
	mm	50	65	80	100	125	150	200	250	300	350	400
L		8.5	9.5	11.12	12.0	15.0	15.88	16.5	18.0	19.8	30.0	33.0
		216	241	282.5	305	381	403	419	457	502	762	838
L1		8.5	9.5	11.12	12.0	15.0	15.9	16.5	18.0	19.8	30.0	33.0
		216	241	282.5	305	381	403	419	457	502	762	838
H app		410	450	485	615	725	835	1015	1230	1555	1720	1970
K app		200	250	250	300	350	350	450	500	500	600	600
WT. Kg app (F/E)		32	35	55	80	100	150	225	350	480	745	1060

### DIMENSION TABLE

VALVE SIZE	IN	18	20	22	24
	mm	450	500	550	600
L		36.0	39.0	43.0	45.0
		914	991	1092	1143
L1		36.0	39.0	43.0	45.0
		914	991	1092	1143
H app		2160	2410	2550	2810
K app		680	760	760	760
WT. Kg app (F/E)		1325	1725	1900	2570

## GATE VALVE CLASS 600 API 600

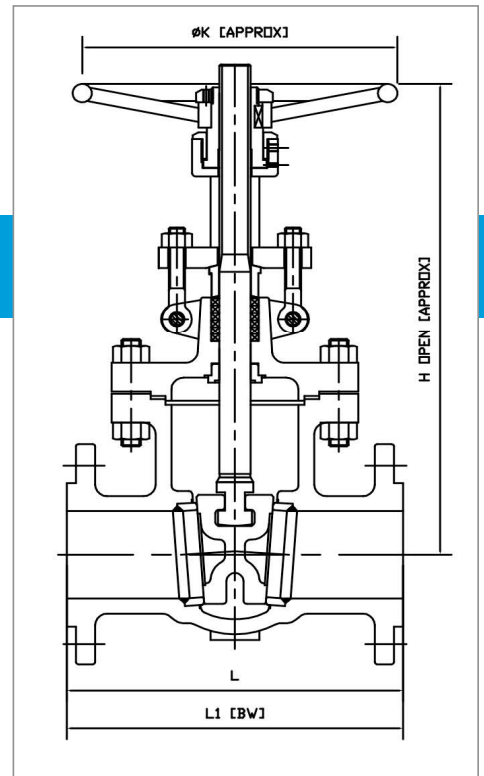

### MATERIAL SPECIFICATION

PARTS	MATERIAL		
	WCB	WC6	CF8/ CF8M
BODY	WCB	WC6	CF8/ CF8M
BONNET	WCB	WC6	CF8/ CF8M
YOKE	WCB	WC6	CF8/ CF8M
WEDGE	13% Cr. FACING ON WCB	13% Cr. FACING ON WC6	CF8/ CF8M
SEAT RING	CA 15/13% Cr. + STELLITED	SS 304/ SS 316 / STELLITED	CF8/ CF8M STELLITED
BACK SEAT	SS 410		INTEGRAL
SPINDLE	SS 410		SS 304/ SS 316
GLAND BUSH	SS 410		SS 304/ SS 316
GLAND FLANGE	WCB/WC6		SS 304
YOKE SLEEVE	ASTM A 439 Gr.D2/ AL BRONZE		
CASING COVER	WCB	WCB/WC6	CF8
HAND WHEEL	CARBON STEEL		
HAND WHEEL NUT	CARBON STEEL		SS 304
STUD & NUT	B7/2H	B16/7	B8/8
EYE BOLT & NUT	B7/2H		B8/8
CASING STUD & NUT	B7/2H		B7 / 2H
CROSS BOLT & NUT	B7/2H		B8/8
GASKET	SPIRAL WOUND SS 304/ SS 316 WITH GRAFOIL FILLER		
GLAND PACKING	GRAFOIL		
GREASE NIPPLE	BRASS / STEEL		
NAME PLATE	ALUMINIUM/SS		
BEARING	STANDARD		

\*MOC & TRIMS CAN BE SUPPLIED AS PER CUSTOMER REQUIREMENT.

### DIMENSION TABLE

VALVE SIZE	IN	2	2.5	3	4	5	6	8	10	12	14	16
	mm	50	6.5	80	100	125	150	200	250	300	350	400
L		11.5	13.0	14.0	17.0	20.0	22.0	26.0	31.0	33.0	35.0	39.0
		292	330	356	432	508	559	660	787	838	889	991
L1		11.5	13.0	14.0	17.0	20.0	22.0	26.0	31.0	33.0	35.0	39.0
		292	330	356	432	508	559	660	787	838	889	991
H app		410	485	560	705	800	895	1125	1400	1535	1825	1955
K app		250	250	350	450	500	600	680	760	760	760	760
WT. Kg app (F/E)		38	56	72	136	170	245	432	780	835	1190	1690

## BOLTED BONNET GATE VALVE CLASS 900/1500/2500 API 600/ASME A B16.34

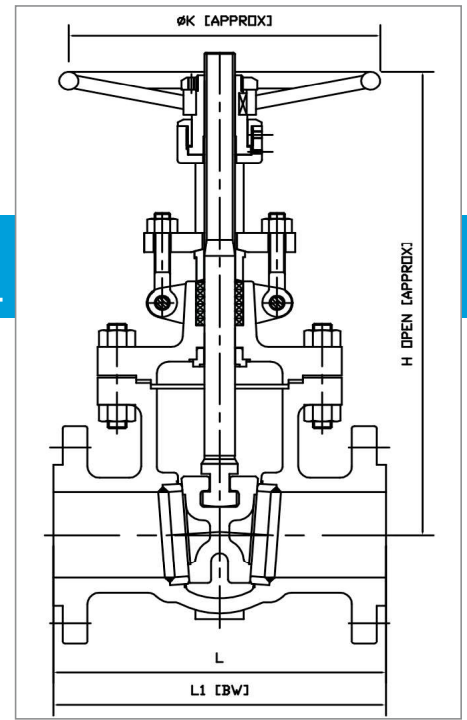

### MATERIAL SPECIFICATION

PARTS	MATERIAL		
BODY	WCB	WC6	CF8/ CF8M
BONNET	WCB	WC6	CF8/ CF8M
YOKE	WCB	WC6	CF8/ CF8M
WEDGE	CA 15 /13% Cr. FACING ON WCB+ STELLITED	WC6 + STELLITED	CF8/ CF8M STELLITED
SEAT RING	13% Cr.+ STELLITED	S.S 304 + STELLITED	SS 304/ SS 316 & CF8/CF8M +STELLITED
BACK SEAT	SS 410		INTEGRAL
SPINDLE	SS 410		SS 304/ SS 316
GLAND BUSH	SS 410		SS 304/ SS 316
GLAND FLANGE	CARBON STEEL / WCB		SS 304
YOKE SLEEVE	ASTM A 439 Gr.D2/ AL BRONZE		
CASING COVER	WCB	WCB/WC6	CF8
HAND WHEEL	CARBON STEEL		
HAND WHEEL NUT	CARBON STEEL		SS 304
STUD & NUT	B7/2H	B16/7	B8/8
EYE BOLT & NUT	B7/2H		B8/8
CASING STUD & NUT	B7/2H		
CROSS BOLT & NUT	B7/2H		B8/8
GASKET	SS 304/ SS 316 RING		
GLAND PACKING	GRAFOIL		
GREASE NIPPLE	BRASS / STEEL		
NAME PLATE	ALUMINIUM/ SS		
BEARING	STANDARD		

\*MOC & TRIMS CAN BE SUPPLIED AS PER CUSTOMER REQUIREMENT.

### DIMENSION TABLE CLASS 900

VALVE SIZE	IN	2	3	4	6	8	10	12	14	16
	mm	50	80	100	150	200	250	300	350	400
L		14.5	15.0	18.0	24.0	29.0	33.0	38.0	40.5	44.5
		368	381	457	610	737	838	965	1029	1130
L1		14.5	15.0	18.0	24.0	29.0	33.0	38.0	40.5	44.5
		368	381	457	610	737	838	965	1029	1130
H app		440	584	712	927	1220	1600	1752	2286	2362
K app		250	300	400	500	600	680	760	760	910
WT. Kg app (F/E)		70	105	190	380	595	975	1275	1665	2310

### DIMENSION TABLE CLASS 1500

VALVE SIZE	IN	2	3	4	6	8	10	12
	mm	50	80	100	150	200	250	300
L		14.5	18.5	21.5	27.8	32.7	39.0	44.5
		368	470	546	705	832	991	1130
L1		14.5	18.5	21.5	27.8	32.7	39.0	44.5
		368	470	546	705	832	991	1130
H app		500	633	725	1045	1310	1410	1550
K app		250	350	400	600	680	910	965
WT. Kg app (F/E)		80	150	225	625	1115	1430	1955

### DIMENSION TABLE CLASS 2500

VALVE SIZE	IN	2	3	4	6
	mm	50	80	100	150
L		17.8	22.8	26.5	36.0
		451	578	673	914
L1		17.8	22.8	26.5	36.0
		451	578	673	914
H app		595	750	805	1200
K app		250	350	400	600
WT. Kg app (F/E)		130	220	320	815

## PRESSURE SEAL GATE VALVE CLASS 900/1500/2500 API 600 ST- A

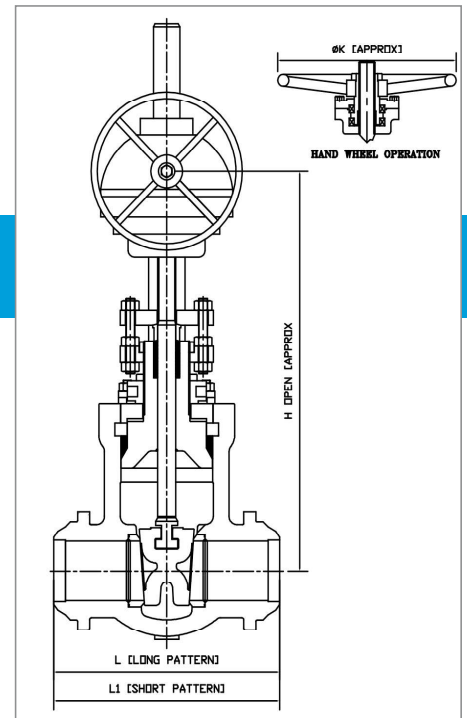

### MATERIAL SPECIFICATION

PARTS	MATERIAL		
BODY	WCB	WC6	CF8/ CF8M
BONNET	WCB	WC6	CF8/ CF8M
YOKE	WCB	WC6	CF8/ CF8M
WEDGE	CA 15/13% Cr. FACING ON WCB+ STELLITED	WC6 + STELLITED	CF8/ CF8M STELLITED
SEAT RING	13% Cr. +STELLITED	SS 304 + STELLITED	SS 304/SS 316 STELLITED
BACK SEAT	INTEGRAL		
SPINDLE	SS 410		SS 304/ SS 316
GLAND BUSH	SS 410		SS 304/ SS 316
GLAND FLANGE	CARBON STEEL/ WCB		SS 304
YOKE SLEEVE	ASTM A 439 Gr.D2/ AL BRONZE		
CASING COVER	WCB	WCB/WC6	CF8
BONNET PLATE	ASTM A 515-70		SS 304
HAND WHEEL	CARBON STEEL		
HAND WHEEL NUT	CARBON STEEL		SS 304
STUD & NUT	B7/2H	B16/7	B8/8
GLAND STUD & NUT	B7/2H		B8/8
CASING STUD & NUT	B7/2H		B8/8
YOKE STUD & NUT	B7/2H		B8/8
GLAND PACKING	GRAFOIL		
SEAL RING	SS 304		SS 304/ SS 316
SPACER RING	ASTMA 515-70	SS 304	SS 304/ SS 316
SEGMENTAL RING	ASTMA 515-70	SS 304	SS 304/ SS 316
NAME PLATE	ALUMINIUM/ SS		
BEARING	STANDARD		

\*MOC & TRIMS CAN BE SUPPLIED AS PER CUSTOMER REQUIREMENT.

### DIMENSION TABLE CLASS 900

VALVE SIZE	IN	2	3	4	6	8	10	12	14
	mm	50	80	100	150	200	250	300	350
L		14.5	15.0	18.0	24.0	29.0	33.0	38.0	40.5
		368	381	457	610	737	838	965	1029
L1		8.5	12.0	14.0	20.0	26.0	31.0	36.0	39.0
		216	305	356	508	660	787	914	991
H app		545	595	720	970	1140	1345	1615	1651
K app		250	300	400	500	600	680	760	760
WT. Kg app		50	75	130	265	430	680	950	1290

### DIMENSION TABLE CLASS 1500

VALVE SIZE	IN	2	3	4	6	8	10	12
	mm	50	80	100	150	200	250	300
L		14.5	18.5	21.5	27.8	32.7	39.0	44.5
		368	470	546	705	832	991	1130
L1		8.5	12.0	16.0	22.0	28.0	34.0	39.0
		216	305	406	559	711	863	991
H app		545	625	900	1085	1290	1420	1580
K app		250	350	400	600	680	910	965
WT. Kg app		55	85	160	440	760	1050	1350

### DIMENSION TABLE CLASS 2500

VALVE SIZE	IN	2	3	4	6	8
	mm	50	80	100	150	200
L		17.8	22.8	26.5	36.0	40.3
		451	578	673	914	1022
L1		11.0	14.5	18.0	24.0	30.0
		279	368	457	610	762
H app		590	800	865	950	1050
K app		250	350	400	600	680
WT. Kg app		85	120	190	520	980

## GLOBE VALVE CLASS 150 BS1873

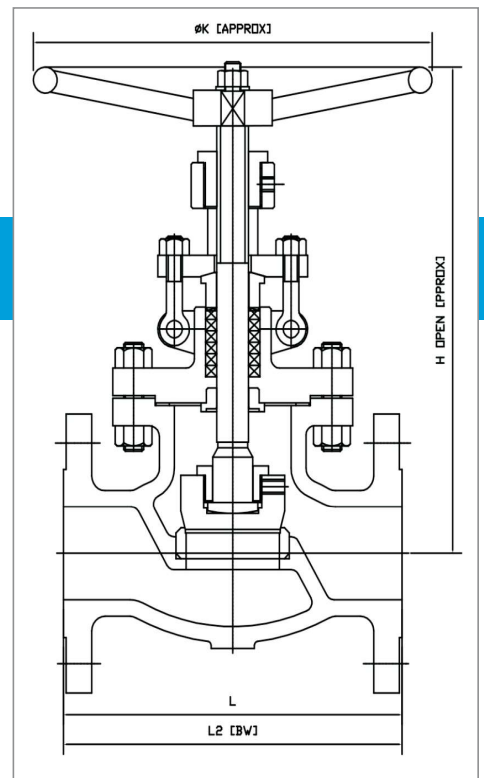

### MATERIAL SPECIFICATION

PARTS	MATERIAL		
	WCB	WC6	CF8/ CF8M
BODY	WCB	WC6	CF8/ CF8M
BONNET	WCB	WC6	CF8/ CF8M
PLUG	CA 15/ 13% Cr. FACING ON WCB	WC6+ 13% Cr.FACING	CF8/ CF8M
SEAT RING	CA 15/ 13% Cr FACING ON WCB	SS 304 / SS 316	CF8/ CF8M
BACK SEAT	SS 410		INTEGRAL
SPINDLE	SS 410		SS 304/ SS 316
GLAND BUSH	SS 410		SS 304/ SS 316
GLAND FLANGE	WCB/WC6		
YOKE NUT	ASTM A 439 Gr.D2/ AL BRONZE		
PLUG NUT	SS 410		SS 304
HAND WHEEL	CARBON STEEL		
HAND WHEEL NUT	Gr. 2H		Gr.8
STUD & NUT	B7 / 2H	B16/7	B8/8
EYE BOLT & NUT	B7/2H		B8/8
CROSS BOLT & NUT	B7/2H		B8/8
GASKET	SPIRAL WOUND SS 304/ SS 316 WITH GRAFOIL FILLER		
GLAND PACKING	GRAFOIL		
THRUST WASHER	SS 410 (HARDENED STEEL)		SS 304/SS 316
WASHER	STEEL		
GRUB SCREW	STEEL		
LOCK NUT	STEEL		
NAME PLATE	ALUMINIUM/ SS		

\*MOC & TRIMS CAN BE SUPPLIED AS PER CUSTOMER REQUIREMENT.

### DIMENSION TABLE

VALVE SIZE	IN	2	2.5	3	4	5	6	8	10	12	14	16	18	20	22	24
	mm	50	6.5	80	100	125	150	200	250	300	350	400	450	500	550	600
L		8.0	8.5	9.5	11.5	14.0	16.0	19.5	24.5	27.5	31.0	36.0	38.5	38.5	42.0	51.0
		203	216	241	292	356	406	495	622	698	787	914	978	978	1067	1295
L1		8.0	8.5	9.5	11.5	14.0	16.0	19.5	24.5	27.5	31.0	36.0	38.5	38.5	42.0	51.0
		203	216	241	292	356	406	495	622	698	787	914	978	978	1067	1295
H app		320	330	380	480	525	575	650	780	935	1185	1250	1350	1410	1525	1650
K app		200	200	250	300	300	350	450	500	600	700	750	800	800	850	900
WT. Kg app (F/E)		20	30	38	57	75	98	155	225	360	580	800	910	1100	1300	1450

## GLOBE VALVE CLASS 300 BS1873

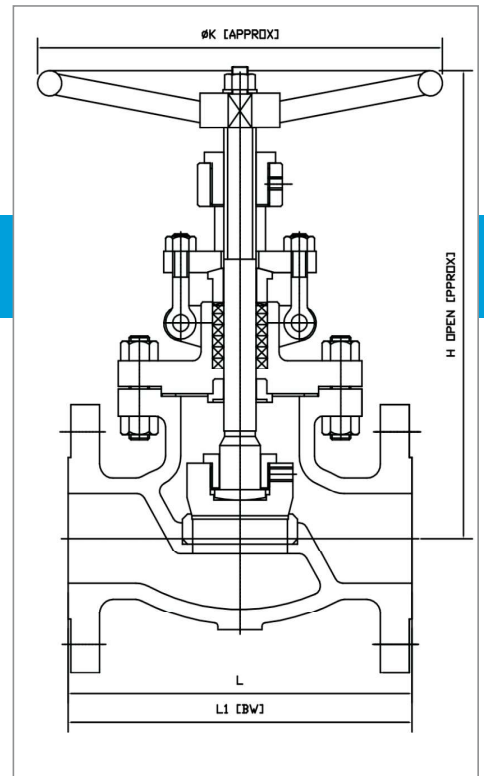

### MATERIAL SPECIFICATION

PARTS	MATERIAL		
	WCB	WC6	CF8/ CF8M
BODY	WCB	WC6	CF8/ CF8M
BONNET	WCB	WC6	CF8/ CF8M
PLUG	CA 15/ 13% Cr. FACING ON WCB	WC6+	CF8/ CF8M
SEAT RING	CA 15/ 13% Cr FACING ON WCB	13% Cr.FACING SS 304 / SS 316	CF8/ CF8M
BACK SEAT	SS 410		INTEGRAL
SPINDLE	SS 410		SS 304/ SS 316
GLAND BUSH	SS 410		SS 304/ SS 316
GLAND FLANGE	WCB/WC6		
YOKE NUT	ASTM A 439 Gr.D2/ AL BRONZE		
PLUG NUT	SS 410		SS 304
HAND WHEEL	CARBON STEEL		
HAND WHEEL NUT	Gr. 2H		Gr.8
STUD & NUT	B7 / 2H	B16/7	B8/8
EYE BOLT & NUT	B7/2H		B8/8
CROSS BOLT & NUT	B7/2H		B8/8
GASKET	SPIRAL WOUND SS 304/ SS 316 WITH GRAFOIL FILLER		
GLAND PACKING	GRAFOIL		
THRUST WASHER	SS 410 (HARDENED STEEL)		SS 304/SS 316
WASHER	STEEL		
GRUB SCREW	STEEL		
LOCK NUT	STEEL		
NAME PLATE	ALUMINIUM/ SS		

\*MOC & TRIMS CAN BE SUPPLIED AS PER CUSTOMER REQUIREMENT.

### DIMENSION TABLE

VALVE SIZE	IN	2	2.5	3	4	5	6	8	10	12	14	16	18	20
	mm	50	6.5	80	100	125	150	200	250	300	350	400	450	500
L		10.5	11.5	12.5	14.0	15.7	17.5	22.0	24.5	28.0	33.0	34.0	38.5	40.0
		267	292	318	356	400	444	559	622	711	838	864	978	1016
L1		10.5	11.5	12.5	14.0	15.7	17.5	22.0	24.5	28.0	33.0	34.0	38.5	40.0
		267	292	318	356	400	444	559	622	711	838	864	978	1016
H app		360	410	450	530	590	650	735	825	950	1145	1370	1422	1475
K app		200	250	300	350	400	450	600	700	750	800	800	850	900
WT. Kg app (F/E)		30	45	60	95	125	150	235	390	590	965	1115	1400	1800

## GLOBE VALVE CLASS 600 BS1873

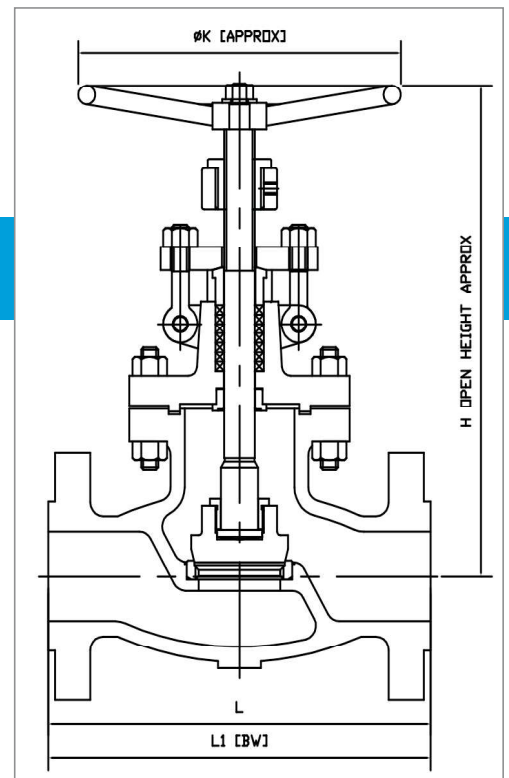

### MATERIAL SPECIFICATION

PARTS	MATERIAL		
BODY	WCB	WC6	CF8/ CF8M
BONNET	WCB	WC6	CF8/ CF8M
PLUG	CA 15/ 13% Cr. FACING ON WCB	WC6 13% Cr. FACING	CF8/ CF8M
SEAT RING	13% Cr.+ STELLITING		CF8/CF8M
BACK SEAT	SS 410		INTEGRAL
SPINDLE	SS 410		SS 304/ SS 316
GLAND BUSH	SS 410		SS 304/ SS 316
GLAND FLANGE	WCB/WC6		SS 304
YOKE NUT	ASTM A 439 Gr.D2/ AL- BRONZE		
PLUG NUT	SS 410		SS 304
HAND WHEEL	CARBON STEEL		
HAND WHEEL NUT	Gr. 2H		Gr.8
STUD & NUT	B7 / 2H	B16/7	B8/8
EYE BOLT & NUT	B7 / 2H	B16/7	B8 /8
CROSS BOLT & NUT	B7/2H		B8/ 8
GASKET	SPIRAL WOND SS 304/ SS 316 WITH GRAFOIL FILLER		
GLAND PACKING	GRAFOIL		
THRUST WASHER	SS 410 (HARDENED STEEL)		SS 304
WASHER	STEEL		
GRUB SCREW	STEEL		
LOCK NUT	STEEL		
NAME PLATE	ALUMINIUM / SS		

\*MOC & TRIMS CAN BE SUPPLIED AS PER CUSTOMER REQUIREMENT.

### DIMENSION TABLE

VALVE SIZE	IN	2	2.5	3	4	5	6	8	10	12
	mm	50	6.5	80	100	125	150	200	250	300
L		11.5	13.0	14.0	17.0	20.0	22.0	26.0	31.0	33.0
		292	330	356	432	508	559	660	787	838
L1		11.5	13.0	14.0	17.0	20.0	22.0	26.0	31.0	33.0
		292	330	356	432	508	559	660	787	838
H app		400	425	490	635	685	740	975	1080	1230
K app		250	300	350	400	450	500	600	650	700
WT. Kg app (F/E)		35	40	68	128	185	250	435	825	910

## BOLTED BONNET GLOBE VALVE CLASS 900/1500/2500 BS 1873/ ASME B16.34

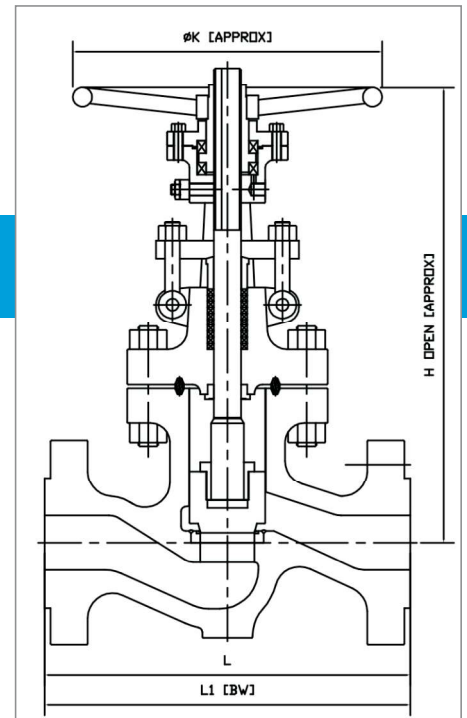

### MATERIAL SPECIFICATION

PARTS	MATERIAL		
BODY	WCB	WC6	CF8/ CF8M
BONNET	WCB	WC6	CF8/ CF8M
PLUG	CA15/ 13% Cr. FACING ON WCB+ STELLITED	WC6 + STELLITED	CF8/ CF8M STELLITED
SEAT RING	13% Cr. + STELLITED	SS 304 + STELLITED	CF8/ CF8M STELLITED
BACK SEAT		SS 410	INTEGRAL
SPINDLE		SS 410	SS 304/ SS 316
GLAND BUSH		SS 410	SS 304/ SS 316
GLAND FLANGE		CARBON STEEL/ WCB	SS 304
YOKE SLEEVE		ASTM A 439 Gr.D2/ AL BRONZE	
PLUG NUT		SS 410	SS 304
CASING COVER	WCB	WCB/WC6	CF8/ CF8M
GUIDE PLATE		CARBON STEEL	
HAND WHEEL		CARBON STEEL	
HAND WHEEL NUT		CARBON STEEL	SS 304
STUD & NUT	B7/2H	B16/7	B8/8
EYE BOLT & NUT		B7/2H	B8/8
CASING STUD & NUT		B7/2H	
CROSS BOLT & NUT		B7/2H	B8/8
GASKET		SS304/ SS 316 RING	
GLAND PACKING		GRAFOIL	
NAME PLATE		ALUMINIUM/ SS	
BEARING		STANDARD	

\*MOC & TRIMS CAN BE SUPPLIED AS PER CUSTOMER REQUIREMENT.

### DIMENSION TABLE CLASS 900

VALVE SIZE	IN	2	3	4	6	8	10
	mm	50	80	100	150	200	250
L		14.5	15.0	18.0	24.0	29.0	33.0
		368	381	457	610	737	838
L1		14.5	15.0	18.0	24.0	29.0	33.0
		368	381	457	610	737	838
H app		505	605	710	895	980	1150
K app		300	400	500	600	700	735
WT. Kg app (F/E)		85	140	240	450	810	1150

### DIMENSION TABLE CLASS 1500

VALVE SIZE	IN	2	3	4	6	8
	mm	50	80	100	150	200
L		14.5	18.5	21.5	27.7	32.7
		368	470	546	705	832
L1		14.5	18.5	21.5	27.7	32.7
		368	470	546	705	832
H app		545	750	865	1048	1188
K app		350	450	500	700	800
WT. Kg app (F/E)		95	155	305	550	900

### DIMENSION TABLE CLASS 2500

VALVE SIZE	IN	2	3	4	6
	mm	50	80	100	150
L		17.7	22.7	26.5	36.0
		451	578	673	914
L1		17.7	22.7	26.5	36.0
		451	578	673	914
H app		610	795	975	1080
K app		400	500	700	750
WT. Kg app (F/E)		115	346	490	910

# PRESSURE SEAL GLOBE VALVE CLASS 900/1500/2500 BS 1873/ ASME B16.34

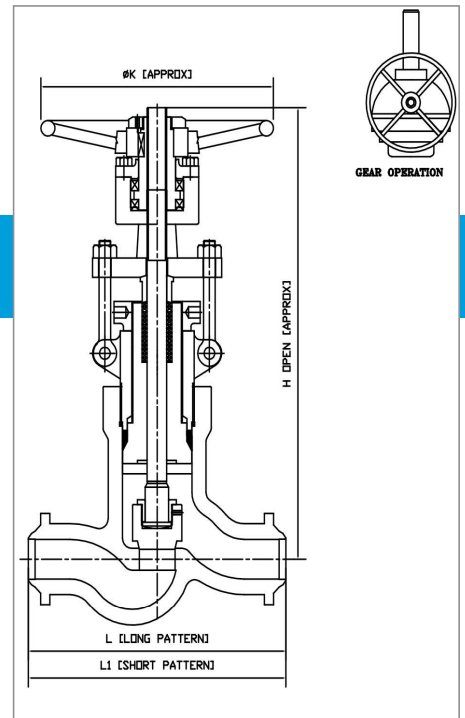

## MATERIAL SPECIFICATION

PARTS	MATERIAL		
BODY	WCB	WC6	CF8/ CF8M
BONNET	WCB	WC6	CF8/ CF8M
YOKE	WCB	WC6	CF8/ CF8M
PLUG	CA15/ 13% Cr. FACING ON WCB+ STELLITED	WC6 + STELLITED	CF8/ CF8M STELLITED
SEAT RING	13% Cr. +STELLITED	SS 304 + STELLITED	SS304/ SS 316 STELLITED
BACK SEAT	INTEGRAL		
SPINDLE	SS 410		SS 304/ SS 316
GLAND BUSH	SS 410		SS 304/ SS 316
GLAND FLANGE	CARBON STEEL/ WCB		SS 304
YOKE SLEEVE	ASTM A 439 Gr.D2/ AL BRONZE		
CASING COVER	WCB	WCB/WC6	CF8
BONNET PLATE	WCB	SS 304	SS 304
GUIDE PLATE	ASTM A 515-70		
HAND WHEEL	CARBON STEEL		
HAND WHEEL NUT	CARBON STEEL		SS 304
STUD & NUT	B7/2H	B16/7	B8/8
GLAND STUD & NUT	B7/2H		B8/8
CASING STUD & NUT	B7/2H		
YOKE STUD & NUT	B7/2H		
GLAND PACKING	GRAFOIL		
SEAL RING	SS 304/ SS 316		
SPACER RING	ASTM A 515-70	SS 304	SS 304/ SS 316
SEGMENTAL RING	ASTM A 515-70	SS 304	SS 304/ SS 316
LOCKING BOLT	Gr. B7		
NAME PLATE	ALUMINIUM/ SS		
BEARING	STANDARD		

\*MOC & TRIMS CAN BE SUPPLIED AS PER CUSTOMER REQUIREMENT.

## DIMENSION TABLE CLASS 900

VALVE SIZE	IN	2	3	4	6	8	10
	mm	50	80	100	150	200	250
L		14.5 368	15.0 381	18.0 457	24.0 610	29.0 737	33.0 838
L1		14.5 368	12.0 305	14.0 356	20.0 508	26.0 660	31.0 787
H app		460	600	740	860	1040	1120
K app		300	400	500	600	700	735
WT. Kg app		80	90	170	310	550	770

## DIMENSION TABLE CLASS 1500

VALVE SIZE	IN	2	3	4	6	8
	mm	50	80	100	150	200
L		14.5 368	18.5 470	21.5 546	27.75 705	32.75 832
L1		8.5 216	12.0 305	16.0 406	22.0 559	28.0 711
H app		480	785	790	1080	1150
K app		350	450	500	700	800
WT. Kg app		65	95	235	340	600

## DIMENSION TABLE CLASS 2500

VALVE SIZE	IN	2	3	4	6
	mm	50	80	100	150
L		17.7 451	22.7 578	26.5 673	36.0 914
L1		11.0 279	14.5 368	18.0 457	24.0 610
H app		610	795	975	1120
K app		400	500	700	750
WT. Kg app		80	270	375	610

## SWING CHECK VALVE CLASS 150 BS1868 / API 6D

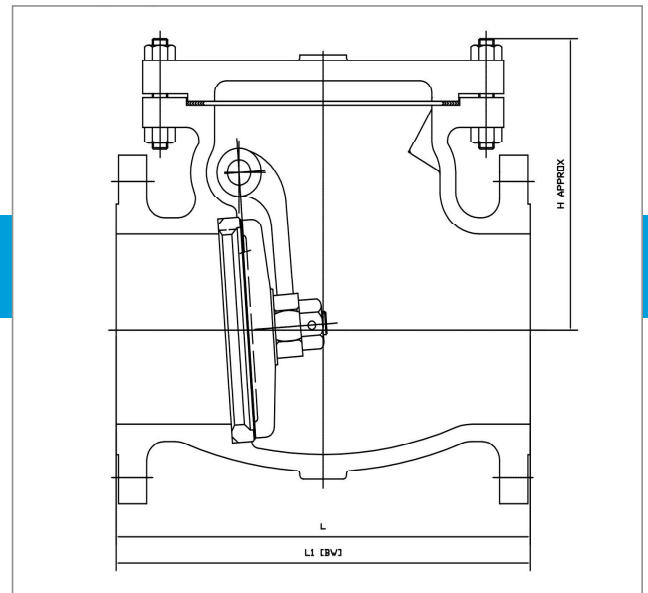

### MATERIAL SPECIFICATION

PARTS	MATERIAL		
BODY	WCB	WC6	CF8/ CF8M
DISC	CA 15/ 13% Cr. FACING ON WCB	WC6+ 13% Cr	CF8/ CF8M
SEAT RING	CA 15/13% Cr FACING ON WCB	CA 15/13% Cr FACING ON WC6	(INTEGRAL)
TOP COVER	WCB	WC6	CF8/ CF8/M
STUD & NUT	B7 /2H	B16 /7	B8/8
BRACKET STUD NUT	B7 /2H	B16 /7	B8/8
GASKET	SPIRAL WOND SS 304/ SS316 WITH GRAFOIL FILLER		
WASHER	SS 410	SS 304	SS 304/ SS 316
DISC NUT	Gr 8	Gr 8	SS 304/ SS 316
HINGE PIN	SS 410/SS 304		SS 304/ SS 316
SPLIT PIN	SS 410	SS 304	SS 304/ SS 316
NAME PLATE	ALUMINIUM/ SS		
HINGE	WCB	WC6	CF8/CF8M
HINGE BRACKET	WCB	WC6	CF8/CF8M
LIFTING EYE BOLT 2	A105		SS 304

\*MOC & TRIMS CAN BE SUPPLIED AS PER CUSTOMER REQUIREMENT.

### DIMENSION TABLE

VALVE SIZE	IN	2	2.5	3	4	5	6	8	10	12	14	16	18	20	22	24
	mm	50	6.5	80	100	125	150	200	250	300	350	400	450	500	550	600
L		8.0	8.5	9.5	11.5	14.0	16.0	19.5	24.5	27.5	31.0	36.0	38.5	38.5	42.0	51.0
		203	216	241	292	330	356	495	622	698	787	864	978	978	1067	1295
L1		8.0	8.5	9.5	11.5	14.0	16.0	19.5	24.5	27.5	31.0	36.0	38.5	38.5	42.0	51.0
		203	216	241	292	330	356	495	622	698	787	864	978	978	1067	1295
H app		145	165	170	205	225	255	300	340	485	465	595	545	600	695	750
WT. Kg app (F/E)		18	25	32	52	56	92	136	220	345	485	570	770	1055	1255	1325

## SWING CHECK VALVE CLASS 300 BS1868 / API 6D

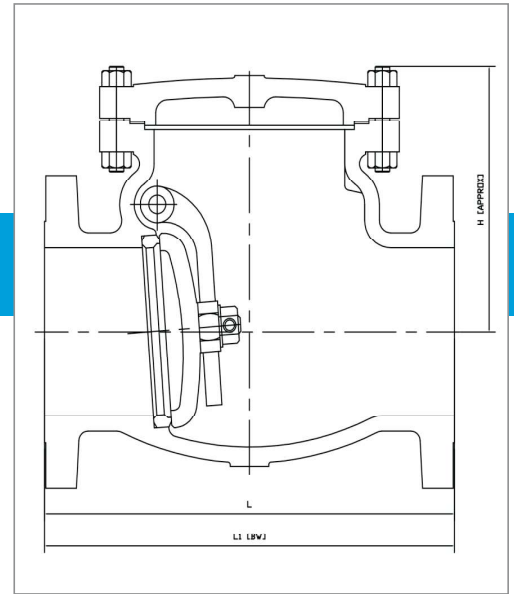

### MATERIAL SPECIFICATION

PARTS	MATERIAL		
BODY	WCB	WC6	CF8/ CF8M
DISC	CA 15/ 13% Cr. FACING ON WCB	WC6+ 13% Cr	CF8/ CF8M
SEAT RING	CA 15/13% Cr FACING ON WCB	CA 15/13% Cr FACING ON WC6	(INTEGRAL)
TOP COVER	WCB	WC6	CF8/ CF8/M
STUD & NUT	B7 /2H	B16 /7	B8/8
BRACKET STUD NUT	B7 /2H	B16 /7	B8/8
GASKET	SPIRAL WOND SS 304/ SS 316 WITH GRAFOIL FILLER		
WASHER	SS 410	SS 304	SS 304/ SS 316
DISC NUT	Gr 8	Gr 8	SS 304/ SS 316
HINGE PIN	SS 410/SS304		SS 304/ SS 316
SPLIT PIN	SS 410	SS 304	SS 304/ SS 316
NAME PLATE	ALUMINIUM/ SS		
HINGE	WCB	WC6	CF8/CF8M
HINGE BRACKET	WCB	WC6	CF8/CF8M
LIFTING EYE BOLT 2	A105		SS 304

\*MOC & TRIMS CAN BE SUPPLIED AS PER CUSTOMER REQUIREMENT.

### DIMENSION TABLE

VALVE SIZE	IN	2	2.5	3	4	5	6	8	10	12	14	16	18	20
	mm	50	6.5	80	100	125	150	200	250	300	350	400	450	500
L		10.5	11.5	12.5	14.0	15.7	17.5	21.0	24.5	28.0	33.0	34.0	38.5	40.0
		267	292	318	356	400	444	533	622	711	838	864	978	1016
L1		10.5	11.5	12.5	14.0	15.7	17.5	21.0	24.5	28.0	33.0	34.0	38.5	40.0
		267	292	318	356	400	444	533	622	711	838	864	978	1016
H app		155	215	185	220	245	275	300	375	430	520	560	686	610
WT. Kg app (F/E)		25	40	60	80	105	130	215	345	470	685	998	1050	1220

## SWING CHECK VALVE CLASS 600 BS1868 / API 6D

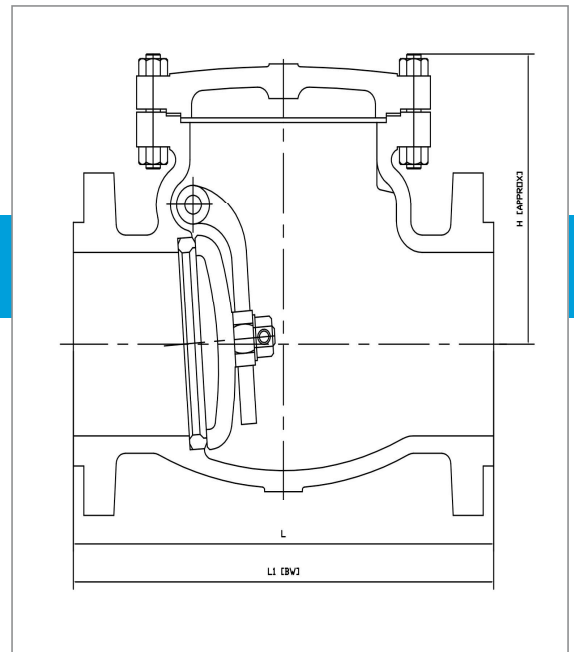

### MATERIAL SPECIFICATION

PARTS	MATERIAL		
BODY	WCB	WC6	CF8/ CF8M
DISC	13% Cr.+STELLITING	13% Cr.+STELLITING	CF8/ CF8M
SEAT RING	13% Cr.+STELLITING	13% Cr.+STELLITING	(INTEGRAL)
TOP COVER	WCB	WC6	CF8/ CF8M
STUD & NUT	B7 /2H	B16 /7	B8/8
BRACKET STUD NUT	B7 /2H	B16 /7	B8/8
GASKET	SPIRAL WOND SS 304/ SS316 WITH GRAFOIL FILLER		
WASHER	SS 410	SS 304	SS 304/ SS 316
DISC NUT	Gr 8	Gr 8	Gr 8
HINGE PIN	SS 410	SS 304	SS 316
SPLIT PIN	SS 410	SS 304	SS 316
NAME PLATE	ALUMINIUM/ SS		
HINGE	WCB	WC6	CF8/CF8M
HINGE BRACKET	WCB	WC6	CF8/CF8M
LIFTING EYE BOLT 2	A105		

\*MOC & TRIMS CAN BE SUPPLIED AS PER CUSTOMER REQUIREMENT.

### DIMENSION TABLE

VALVE SIZE	IN	2	2.5	3	4	5	6	8	10	12	14	16
	mm	50	6.5	80	100	125	150	200	250	300	350	400
L		11.5	13.0	14.0	17.0	22.0	20.0	26.0	31.0	33.0	35.0	39.0
		292	330	356	432	508	559	660	787	838	889	991
L1		11.5	13.0	14.0	17.0	20.0	22.0	26.0	31.0	33.0	35.0	39.0
		292	330	356	432	508	559	660	787	838	889	991
H app		160	260	230	280	290	330	360	475	555	580	665
WT. Kg app (F/E)		29	55	65	115	145	250	405	620	815	970	1215

## BOLTED COVER SWING CHECK VALVE CLASS 900/1500/2500 BS 1868/ ASME B16.34

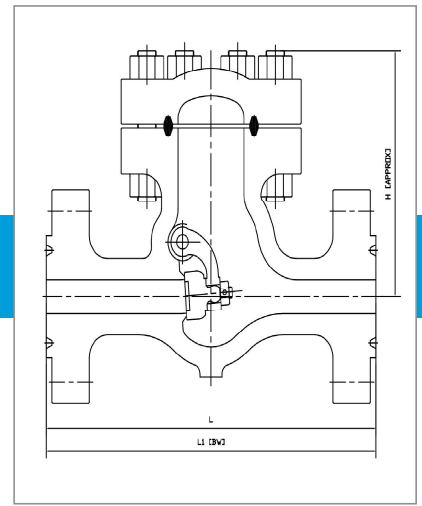

### MATERIAL SPECIFICATION

PARTS	MATERIAL		
	WCB	WC6	CF8/ CF8M
BODY	WCB	WC6	CF8/ CF8M
DISC	CA15/ 13% Cr. FACING ON WCB+ STELLITED	WC6 + STELLITED	CF8/ CF8M STELLITED
SEAT RING	13% Cr. + STELLITED	SS 304 + STELLITED	SS 304/ SS 316+ STELLITED
TOP COVER	WCB	WC6	CF8/ CF8M
STUD & NUT	B7/2H	B16/7	B8/ 8
BRACKET STUD & NUT		B8/8	
GASKET	SS 304/ SS 316 RING		
WASHER	SS 410	SS 304	SS 316
DISC NUT		Gr. 8	
HINGE PIN	SS 410	SS 304	SS 316
SPLIT PIN	SS 410	SS 304	SS 316
NAME PLATE	ALUMINIUM/ SS		
HINGE	WCB	WC6	CF8/ CF8M
HINGE BRACKET	WCB	WC6	CF8/ CF8M
LIFTING EYE BOLT	ASTM A 105		

\*MOC & TRIMS CAN BE SUPPLIED AS PER CUSTOMER REQUIREMENT.

### DIMENSION TABLE CLASS 900

VALVE SIZE	IN	2	3	4	6	8	10	12	14	16
	mm	50	80	100	150	200	250	300	350	400
L		14.5	15.0	18.0	24.0	29.0	33.0	38.0	40.5	44.5
		368	381	457	610	737	838	965	1029	1130
L1		14.5	15.0	18.0	24.0	29.0	33.0	38.0	40.5	44.5
		368	381	457	610	737	838	965	1029	1130
H app		220	280	350	450	525	600	675	750	825
WT. Kg app (F/E)		55	90	135	295	525	900	1075	1225	1450

### DIMENSION TABLE CLASS 1500

VALVE SIZE	IN	2	3	4	6	8	10	12
	mm	50	80	100	150	200	250	300
L		14.5	18.5	21.5	27.7	32.7	39.0	44.5
		368	470	546	705	832	991	1130
L1		14.5	18.5	21.5	27.5	32.7	39.0	44.5
		368	470	546	705	832	991	1130
H app		220	280	370	450	600	660	750
WT. Kg app (F/E)		70	115	175	370	680	980	1250

### DIMENSION TABLE CLASS 2500

VALVE SIZE	IN	2	3	4	6	8
	mm	50	80	100	150	200
L		17.7	22.7	26.5	36.0	40.2
		451	578	673	914	1022
L1		17.7	22.7	26.5	36.0	40.2
		451	578	673	914	1022
H app		305	390	415	565	640
WT. Kg app (F/E)		95	125	240	515	575

## PRESSURE SEAL SWING CHECK VALVE CLASS 900/1500/2500 BS 1868/ ASME B16.34

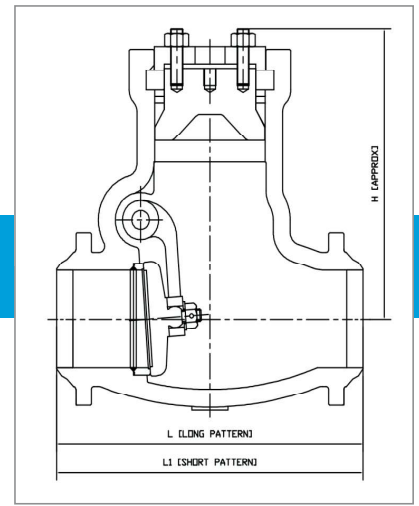

### MATERIAL SPECIFICATION

PARTS	MATERIAL		
	WCB	WC6	CF8/ CF8M
BODY	WCB	WC6	CF8/ CF8M
DISC	CA15/ 13% Cr. FACING ON WCB+ STELLITED	WC6 + STELLITED	CF8/ CF8M STELLITED
SEAT RING	13% Cr. + STELLITED	SS 304 + STELLITED	SS304/ SS316+ STELLITED
TOP COVER	WCB	WC6	CF8/ CF8M
INNER PLATE	WCB	SS 304/ WC6	SS 304
STUD & NUT	B7/2H	B16/7	B8/8
BRACKET STUD & NUT		B8/8	
SEAL RING		SS 304/ SS 316	
SPACER RING	ASTMA 515-70	SS 304	SS304/ SS 316
SEGMENTAL RING	ASTMA 515-70	SS 304	SS 304/ SS 316
WASHER		SS 304	SS 304/ SS 316
DISC NUT		Gr. 8	
HINGE PIN	SS 410	SS 304	SS 304/ SS 316
SPLIT PIN		SS 304/ SS 316	
NAME PLATE		ALUMINIUM/ SS	
HINGE	WCB	WC6/ CF8	CF8/ CF8M
HINGE BRACKET	WCB	WC6/ CF8	CF8/ CF8M
LIFTING EYE BOLT		ASTM A 105	

\*MOC & TRIMS CAN BE SUPPLIED AS PER CUSTOMER REQUIREMENT.

### DIMENSION TABLE CLASS 900

VALVE SIZE	IN	2	3	4	6	8	10
	mm	50	80	100	150	200	250
L		14.5	15.0	18.0	24.0	29.0	33.0
		368	381	457	610	737	838
L1		14.5	15.0	18.0	24.0	29.0	33.0
		368	381	457	610	737	838
H app		220	280	350	450	525	600
WT. Kg app		55	90	135	295	525	900

### DIMENSION TABLE CLASS 1500

VALVE SIZE	IN	2	3	4	6	8
	mm	50	80	100	150	200
L		14.5	18.5	21.5	27.7	32.7
		368	470	546	705	832
L1		14.5	18.5	21.5	27.5	32.7
		368	470	546	705	832
H app		220	280	370	450	600
WT. Kg app		70	115	175	370	680

### DIMENSION TABLE CLASS 2500

VALVE SIZE	IN	2	3	4	6
	mm	50	80	100	150
L		17.7	22.7	26.5	36.0
		451	578	673	914
L1		17.7	22.7	26.5	36.0
		451	578	673	914
H app		305	390	415	565
WT. Kg app		95	125	240	515

## FLOATING BALL VALVE CLASS 150 (2/3 -PIECE) BS 5351 / API 6D

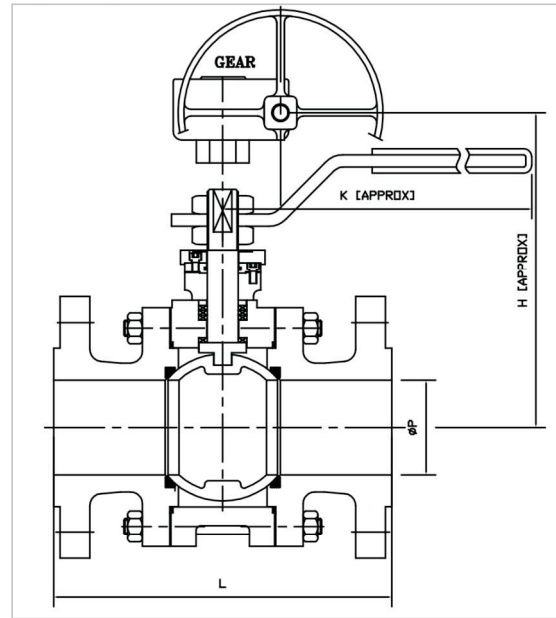
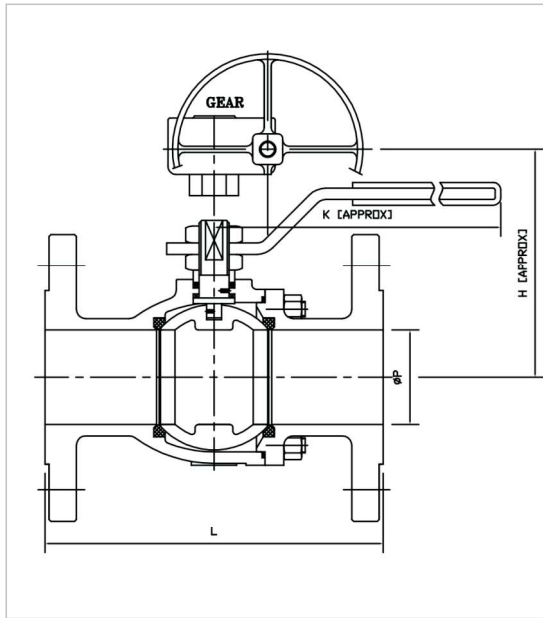

### MATERIAL SPECIFICATION

PARTS	MATERIAL		
	WCB	CF8	CF8M
BODY	WCB	CF8	CF8M
BALL	SS 304/CF8		
SEAT	PTFE		
SPINDLE	SS 410/ SS 304	SS 304	SS 316
GLAND BUSH	SS 410/ SS 304	SS 304	SS 316
HANDLE	STEEL WITH PVC CAP		
HANDLE NUT	STEEL	SS 304	SS 304
STUD & NUT	B7 / 2H		B8/8
GASKET	PTFE		
GLAND PACKING	PTFE		
BOTTOM WASHER	PTFE		
END PIECE	WCB	CF8	CF8M
GLAND NUT	CARBON STEEL	SS 304	SS 316
NAME PLATE	ALUMINIUM/ SS		
POSITION INDICATOR	ALUMINIUM/ SS		

\*MOC & TRIMS CAN BE SUPPLIED AS PER CUSTOMER REQUIREMENT.

### DIMENSION TABLE 150 CLASS

VALVE SIZE	IN	1.5	2	2.5	3	4	6	8	10	12
	mm	40	50	65	80	100	150	200	250	300
L		6.5	7.0	7.5	8.0	9.0	15.5	18.0	21.0	24.0
		165	178	191	203	229	394	457	533	610
H app		100	125	140	150	180	270	325	390	540
K app		220	220	320	320	385	500	600	450	450
P		37	49	64	75	98	148	198	248	298
WT. Kg app (F/E)		9	14	20	27	40	90	165	225	325

## FLOATING BALL VALVE CLASS 300 (2/3 -PIECE) BS 5351 / API 6D

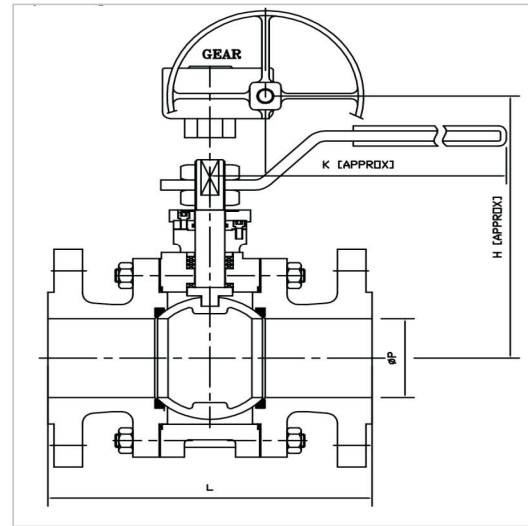
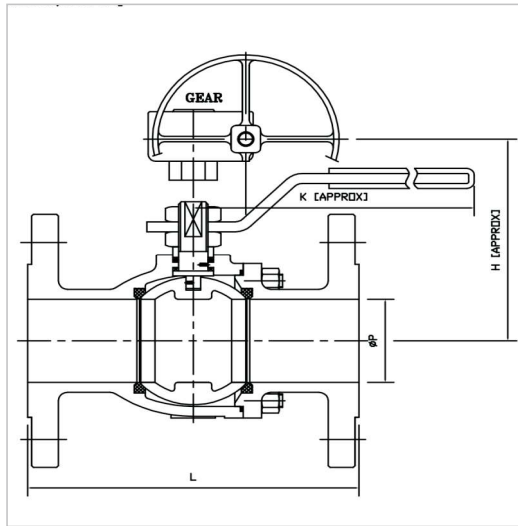

### MATERIAL SPECIFICATION

PARTS	MATERIAL		
	WCB	CF8	CF8M
BODY	WCB	CF8	CF8M
BALL	SS 304/CF8		SS 316/CF8M
SEAT	PTFE		
SPINDLE	SS 410/ SS 304	SS 304	SS 316
GLAND BUSH	SS 410/ SS 304	SS 304	SS 316
HANDLE	STEEL WITH PVC CAP		
HANDLE NUT	STEEL	SS 304	
STUD & NUT	B7 / 2H		B8/8
GASKET	PTFE		
GLAND PACKING	PTFE		
BOTTOM WASHER	PTFE		
END PIECE	WCB	CF8	CF8M
GLAND NUT	CARBON STEEL	SS 304	SS 316
NAME PLATE	ALUMINIUM/ SS		
POSITION INDICATOR	ALUMINIUM/ SS		

\*MOC & TRIMS CAN BE SUPPLIED AS PER CUSTOMER REQUIREMENT.

### DIMENSION TABLE 300 CLASS

VALVE SIZE	IN	1.5	2	2.5	3	4	6	8
	mm	40	50	65	80	100	150	200
L		7.5	8.5	9.5	11.1	12.0	15.9	19.75
		190	216	241	282	305	403	502
H app		120	135	150	170	190	300	360
K app		220	220	320	320	385	500	450
P		37	49	64	75	98	148	198
WT. Kg app (F/E)		12	18	28	35	55	110	235

## TRUNNION MOUNTED BALL VALVE CLASS 150/300 (2/3 -PIECE) BS 5351 / API 6D

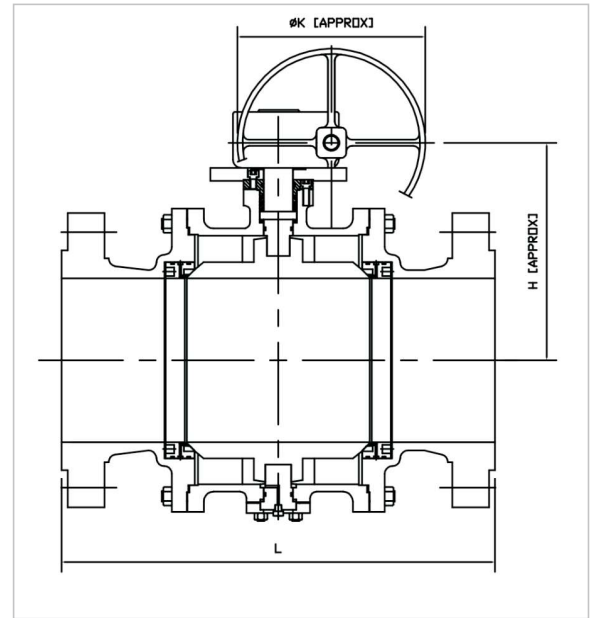
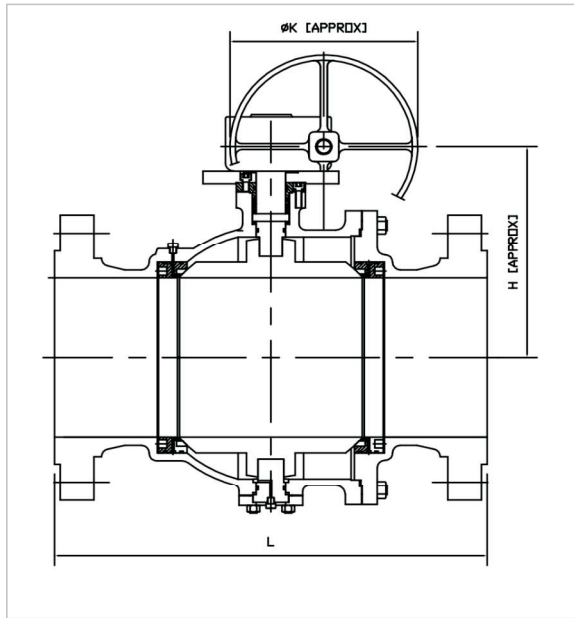

### MATERIAL SPECIFICATION

PARTS	MATERIAL		
BODY	WCB	CF8	CF8M
BALL	WCB/CF8	CF8	CF8M
SEAT	PTFE		
SPINDLE	SS 304	SS 304	SS 316
GLAND BUSH	SS 410/ SS 304	SS 304	SS 316
HAND WHEEL	CARBON STEEL		
STUD & NUT	B7/ 2H	B8/8	B8/8
GLAND STUD & NUT	B7/ 2H	B8/8	B8/8
YOKE STUD & NUT		B7/ 2H	
MOUNTING STUD & NUT		B7/ 2H	
CROSS PIN	SS 410	SS 304	SS 316
TRUNNION STUD & NUT		B7/2H	
GASKET	PTFE		
GLAND PACKING	PTFE		
BOTTOM WASHER	PTFE		
END PIECE	WCB	CF8	CF8M
SEAT RETAINER		SS 304	SS 316
NAME PLATE	ALUMINIUM/ SS		
TOP HEAD	WCB	CF8	CF8M
BOTTOM HEAD	WCB	CF8	CF8M
GEAR BOX ASSLY	COMMERCIAL		
SPRING		SS 304	SS 316
'O' RING	NEOPRENE		
BOTTOM GASKET	SPW SS 304/ SS 316 WITH PTFE FILLER		
POSITION INDICATOR	ALUMINIUM/ SS		

### DIMENSION TABLE 150 CLASS

VALVE SIZE	IN	12	14	16	18	20	24
	mm	300	350	400	450	500	600
L		24.0	28.0	30.0	34.0	36.0	42.0
		610	686	762	864	914	1067
H app		441	481	598	643	708	863
K app		500	500	500	550	500	550
WT. Kg app (F/E)		410	570	710	9050	1220	1650

### DIMENSION TABLE 300 CLASS

VALVE SIZE	IN	12	14	16
	mm	300	350	400
L		25.5	30.0	33.0
		648	762	838
H app		441	481	598
K app		500	500	500
WT. Kg app (F/E)		675	1055	1425

## TRUNNION MOUNTED BALL VALVE CLASS 600 (2/3 -PIECE) BS 5351 / API 6D

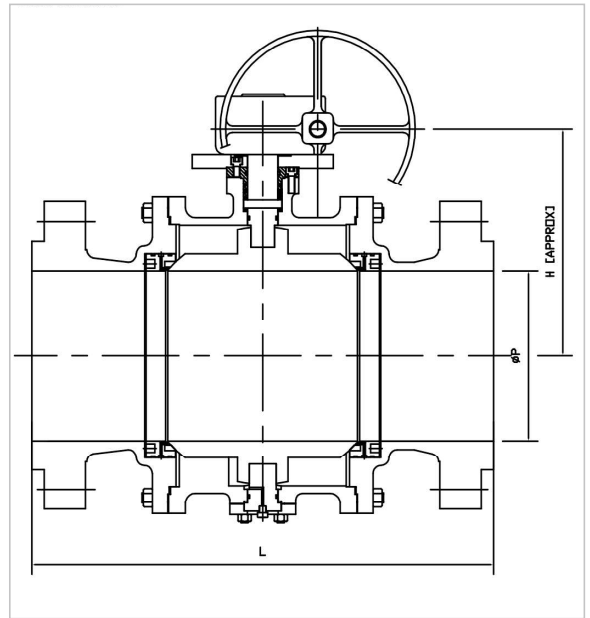
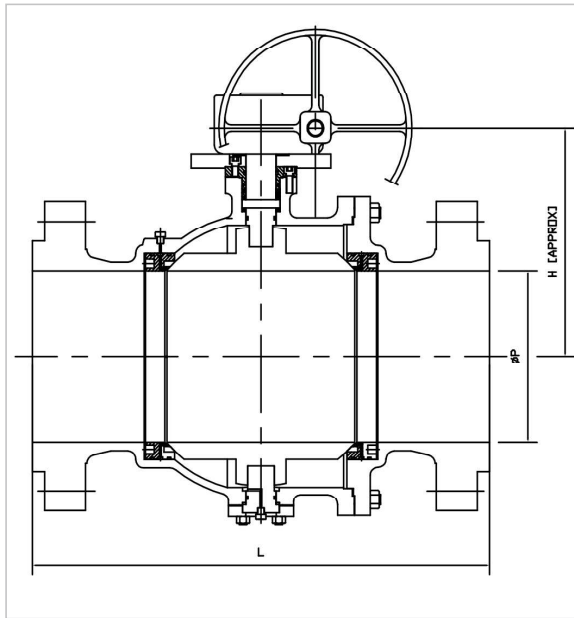

### MATERIAL SPECIFICATION

PARTS	MATERIAL		
	WCB	CF8	CF8M
BODY	WCB	CF8	CF8M
YOKE	WCB	CF8	CF8M
BALL	WCB/CF8	CF8	CF8M
SEAT		PTFE	
SPINDLE	SS 410/ SS 304	SS 304	SS 316
GLAND BUSH	SS 410/ SS 304	SS 304	SS 316
GLAND FLANGE	CARBON STEEL		SS 304
HAND WHEEL		CARBON STEEL	
STUD & NUT	B7/2H		B8/8
GLAND STUD & NUT	B7/2H		B8/8
YOKE STUD & NUT		B7/ 2H	
MOUNTING BOLTS		B7	
CROSS PIN	SS 410	SS 304	SS 316
TRUNNION STUD & NUT		B7/ 2H	
GASKET		SPW SS 304/ SS 316 WITH PTFE FILLER	
GLAND PACKING		PTFE	
BOTTOM WASHER		PTFE	
END PIECE	WCB	CF8	CF8M
SEAT RETAINER	CARBON STEEL	SS 304	SS 316
NAME PLATE		ALUMINIUM / SS	
TRUNNION SUPPORT	CS	SS 304	SS 316
GEAR BOX ASSEMBLY		COMMERCIAL	
SPRING		SS 304	SS 316
'O' RING		NEOPRENE	
BOTTOM GASKET		SPW SS 304/ SS 316 WITH PTFE FILLER	

\*MOC & TRIMS CAN BE SUPPLIED AS PER CUSTOMER REQUIREMENT.

### DIMENSION TABLE 600 CLASS

VALVE SIZE	IN	1.5	2	2.5	3	4	6	8
	mm	40	50	65	80	100	150	200
L		9.5	11.5	13.0	14.0	17.0	22.0	26.0
		241	292	330	356	432	559	660
H app		125	135	150	200	250	450	500
K app		220	320	350	400	450	450	500
P		37	49	64	75	98	148	198
WT. Kg app (F/E)		22	30	35	55	75	165	325

## BALL VALVE CLASS 800 BS 5351

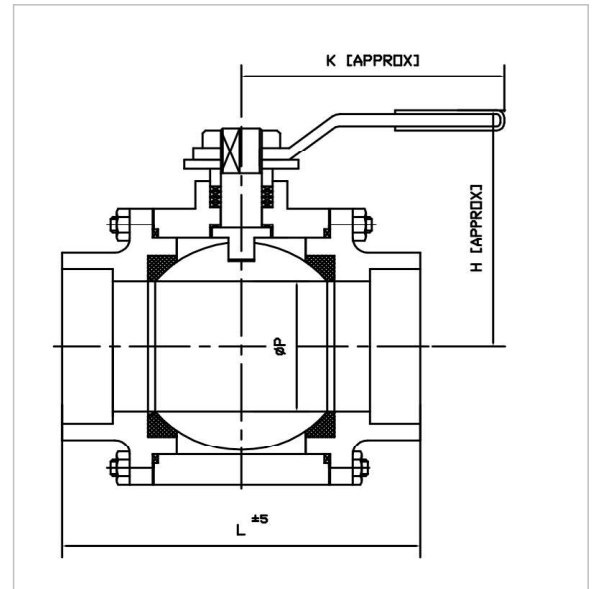
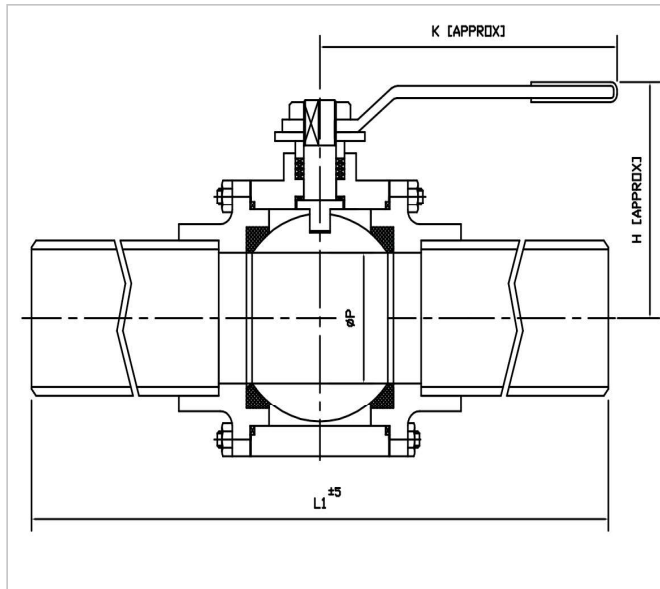

### MATERIAL SPECIFICATION

PARTS	MATERIAL		
	A105	F 304	F 316
BODY	A105	F 304	F 316
BALL	SS 304		
SEAT	PTFE		
SPINDLE	SS 410/ SS 304	SS 304	SS 316
GLAND BUSH	SS 410/ SS 304	SS 304	SS 316
HANDLE	STEEL WITH PVC CAP		
HANDLE NUT	SS 410	SS 304	
STUD & NUT	B7/ 2H	B8/8	
GASKET	PTFE		
GLAND PACKING	PTFE		
BOTTOM WASHER	PTFE		
END PIECE	A 105	F 304	F 316
GLAND NUT	SS 410	SS 304	SS 316
NAME PLATE	ALUMINIUM / SS		
POSITION INDICATOR	ALUMINIUM / SS		

### DIMENSION TABLE CLASS 800

VALVE SIZE	IN	0.5	0.75	1	1.25	1.5	2
	mm	15	20	25	32	40	50
L		3.1	3.3	3.9	4.5	5.1	5.9
		80	85	100	115	130	150
L1		10.8	11.0	11.8	12.4	12.6	13.8
		275	280	300	315	320	350
H app		70	80	90	105	110	125
K app		130	140	160	240	240	240
p		12	19	24	30	37	50
Wt. Kg app (F/E)		1.4	2	3.5	6	7	8

# FORGED STEEL GATE & GLOBE VALVE CLASS 800

## BS 5352 / API 602

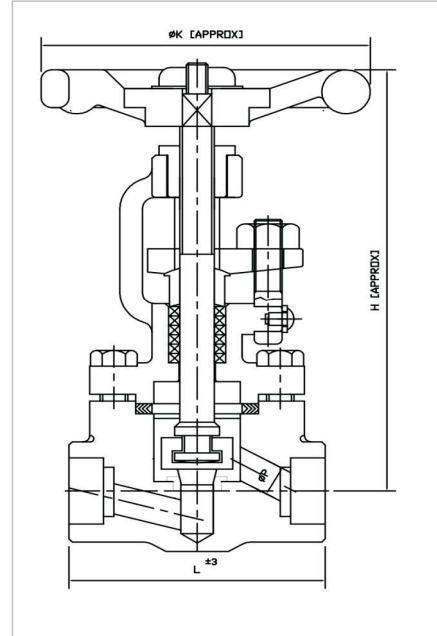
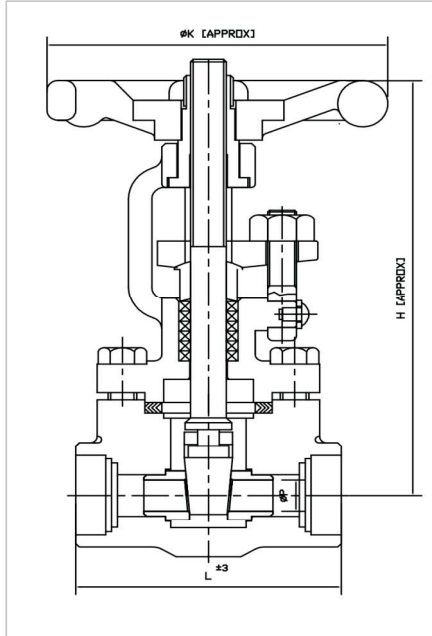

### MATERIAL SPECIFICATION

PARTS	MATERIAL		
BODY	A 105	F 304	F 316
BONNET	A 105	F 304	F 316
WEDGE / PLUG	13% Cr.	SS 304	SS 316
SEAT	13% Cr.	SS 304	SS 316
SPINDLE	SS 410	SS 304	SS 316
GLAND BUSH	SS 410	SS 304	SS 316
GLAND FLANGE	A 105	F 304	
YOKE SLEEVE	ASTMA 439 Gr. D2/ AL-BRONZE		
YOKE NUT	CARBON STEEL		
HAND WHEEL	CAST STEEL		
HAND WHEEL NUT	Gr. 2H		
HEX BOLT/ STUD & NUT	B7/2H	B8/8	
EYE BOLT & NUT	B7/2H	B8/8	
GASKET	SPW SS 304/316 WITH PTFE FILLER / GRAFOIL FILLER		
GLAND PACKING	GRAFOIL		
SCREW / RIVET & WASHER	STEEL		
BEARING WASHER	HARDENED STEEL	SS 304	SS 316
GRUB SCREW	Gr.B7		
GREASE NIPPLE	C.S (NICKLE PLATED)		
NAME PLATE	ALUMINIUM/SS		

**DIMENSION TABLE GTV - REDUCED BORE**

VALVE SIZE	IN	0.25	0.37	0.5	0.75	1	1.5	2
	mm	08	10	15	20	25	40	50
L		3.3	3.3	3.3	3.5	4	5	5.6
		85	85	85	90	103	128	142
H app		165	165	165	175	215	270	285
K app		95	95	95	95	95	105	150
P		6.4	6.4	9.5	12.7	17.5	28.6	36.5
WT. Kg app		2.0	2.0	2.0	2.5	3.5	7.5	9.0

**DIMENSION TABLE GBV - REDUCED BORE**

VALVE SIZE	IN	0.25	0.37	0.5	0.75	1	1.5	2
	mm	08	10	15	20	25	40	50
L		3.3	3.3	3.3	3.5	4	5	5.6
		85	85	85	90	103	128	142
H app		170	170	170	180	210	280	290
K app		95	95	95	95	95	150	150
P		6.0	6.0	9.0	12.0	17.5	29.5	35.0
WT. Kg app		2.0	2.0	2.0	2.5	4.0	8.5	9.0

**DIMENSION TABLE GTV - FULL BORE**

VALVE SIZE	IN	0.25	0.37	0.5	0.75	1	1.5
	mm	08	10	15	20	25	40
L		3.3	3.3	3.3	3.5	4	5
		85	85	90	90	103	128
H app		165	165	175	175	220	270
K app		95	95	95	95	105	150
P		6.0	9.0	12.0	18.0	23.0	36.0
WT. Kg app		2.0	2.0	2.5	3.5	7.5	7.5

**DIMENSION TABLE GBV - FULL BORE**

VALVE SIZE	IN	0.25	0.37	0.5	0.75	1	1.5
	mm	08	10	15	20	25	40
L		3.3	3.3	3.5	4	5	5.6
		85	85	90	103	128	142
H app		170	170	180	210	280	290
K app		95	95	95	105	150	150
P		6.0	9.0	12.0	17.5	22.5	35.5
WT. Kg app		2.0	2.0	2.5	4.5	8.5	9.0

## WELDED BONNET FORGED STEEL VALVE CLASS 1500/2500

### BS 5352 / API 602 / ASME B 16.34

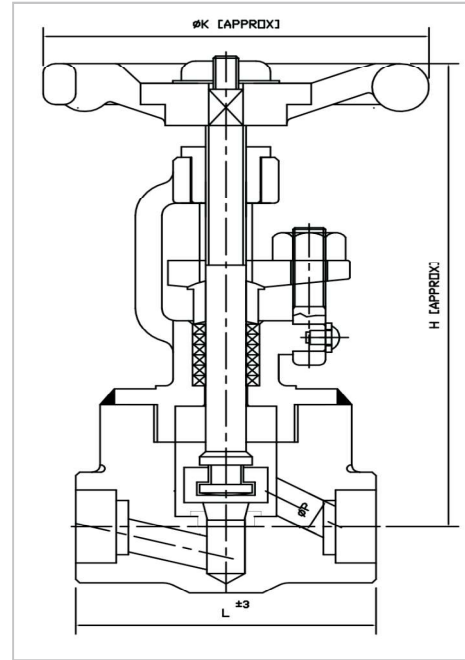
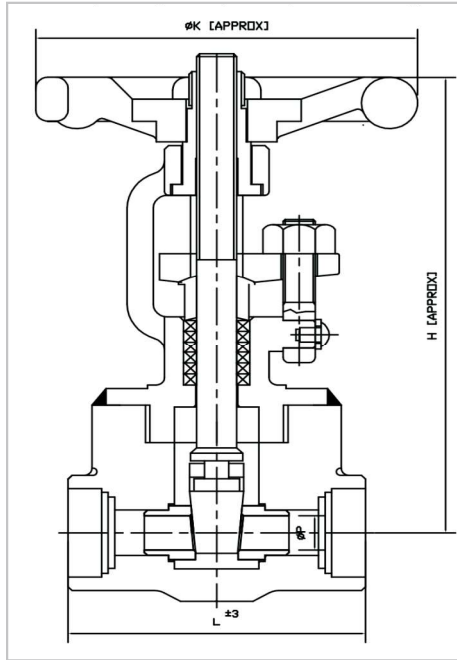

#### MATERIAL SPECIFICATION

PARTS	MATERIAL		
BODY	A 105	F 304	F 316
BONNET	A 105	F 304	F 316
WEDGE / PLUG	13% Cr.	SS 304	SS 316
SEAT	13% Cr.	SS 304	SS 316
SPINDLE	SS 410	SS 304	SS 316
GLAND BUSH	SS 410	SS 304	SS 316
GLAND FLANGE	A 105	F 304	
YOKE SLEEVE	ASTMA 439 Gr. D2/ AL-BRONZE		
YOKE NUT	CARBON STEEL		
HAND WHEEL	CAST STEEL		
HAND WHEEL NUT	Gr. 2H		
EYE BOLT & NUT	B7/2H	B8/8	
GLAND PACKING	GRAFOIL		
SCREW / RIVET & WASHER	STEEL		
BEARING WASHER	HARDENED STEEL	SS 304	SS 316
GRUB SCREW	Gr.B7		
GREASE NIPPLE	C.S (NICKLE PLATED)		
NAME PLATE	ALUMINIUM/SS		

\*MOC & TRIMS CAN BE SUPPLIED AS PER CUSTOMER REQUIREMENT.

**DIMENSION TABLE GTV - 1500 CLASS**

VALVE SIZE	IN	0.25	0.37	0.5	0.75	1	1.5
	mm	08	10	15	20	25	40
L		90	90	103	103	128	142
H app		160	160	205	205	260	275
K app		105	105	140	140	150	150
WT. Kg app		2.6	2.6	3.6	3.6	7.6	10

**DIMENSION TABLE GTV - 2500 CLASS**

VALVE SIZE	IN	0.25	0.37	0.5	0.75	1	1.5
	mm	08	10	15	20	25	40
L		90	90	103	125	128	142
H app		160	160	205	260	260	275
K app		105	105	140	150	150	150
WT. Kg app		2.6	2.6	3.6	7.6	7.6	10

**DIMENSION TABLE GBV - 2500 CLASS**

VALVE SIZE	IN	0.25	0.37	0.5	0.75	1	1.5
	mm	08	10	15	20	25	40
L		90	90	103	103	128	142
H app		160	160	205	205	270	280
K app		105	105	140	140	150	150
WT. Kg app		2.6	2.6	3.6	3.6	7.6	10

**DIMENSION TABLE GBV - 2500 CLASS**

VALVE SIZE	IN	0.25	0.37	0.5	0.75	1	1.5
	mm	08	10	15	20	25	40
L		90	90	103	125	128	142
H app		160	160	205	270	270	280
K app		105	105	140	150	150	150
WT. Kg app		2.6	2.6	3.6	7.6	7.6	10

## FORGED STEEL LIFT CHECK VALVE CLASS 800 / 1500 / 2500 BS 5352

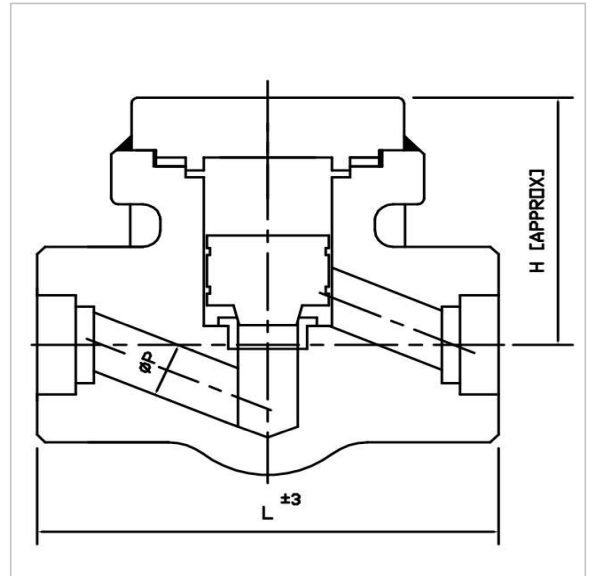
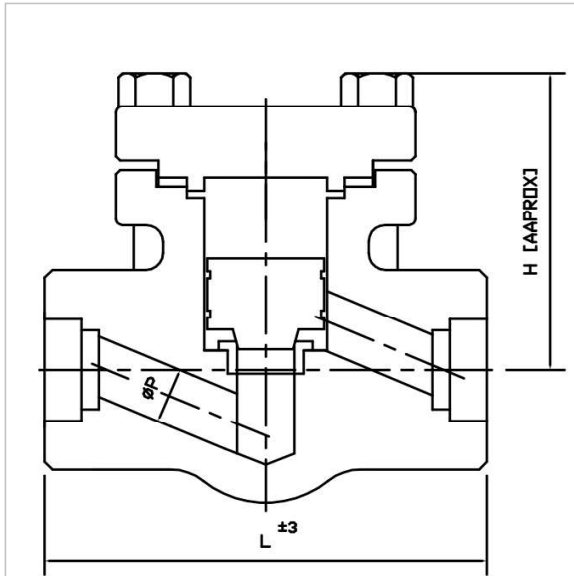

### MATERIAL SPECIFICATION

PARTS	A105	F 304	F 316
BODY	A105	F 304	F 316
PLUG	13%Cr.	SS 304	SS 316
SEAT RING	13% Cr.	SS 304	SS 316
COVER	A 105	F 304	F 316
COLLAR BOLT / STUD & NUT	B7 / 2H	B8/8	
GASKET	SPW SS 304/ SS 316 WITH GRAFOIL FILLER		
NAME PLATE	ALUMINIUM/SS		

### MATERIAL SPECIFICATION

PARTS	A105	F 304	F 316
BODY	A105	F 304	F 316
PLUG	13%Cr. STELLITED	SS 304 STELLITED	SS 316 STELLITED
SEAT RING	13% Cr. STELLITED	SS 304 STELLITED	SS 316 STELLITED
TOP COVER	A 105	F 304	F 316
SPRING	SS 304/ SS316		
NAME PLATE	ALUMINIUM/SS		

\*MOC & TRIMS CAN BE SUPPLIED AS PER CUSTOMER REQUIREMENT.

### DIMENSION TABLE LCV-800 CLASS-REDUCED BORE

VALVE SIZE	IN	0.25	0.37	0.5	0.75	1	1.5	2
	mm	08	10	15	20	25	40	50
L		3.3	3.3	3.3	3.5	4	5	5.6
		85	85	85	90	103	128	142
H app		60	60	60	70	80	105	115
P		6.0	9.0	12.0	17.5	29.5	35.0	
WT. Kg app		1.5	1.5	1.5	2.0	2.5	6	8

### DIMENSION TABLE LCV- 1500 CLASS

VALVE SIZE	IN	0.25	0.37	0.5	0.75	1	1.5
	mm	08	10	15	20	25	40
L		90	90	103	103	128	142
H app		60	60	70	70	90	112
WT. Kg app		2	2	4	4	8	9.5

### DIMENSION TABLE LCV-800 CLASS-FULL BORE

VALVE SIZE	IN	0.25	0.37	0.5	0.75	1	1.5
	mm	08	10	15	20	25	40
L		3.3	3.3	3.5	4	5	5.6
		85	85	90	103	128	142
H app		60	60	70	80	105	115
P		6.0	9.0	12.0	17.5	22.5	35.0
WT. Kg app		1.5	1.5	2.0	2.5	6	8

### DIMENSION TABLE LCV-2500 CLASS

VALVE SIZE	IN	0.25	0.37	0.5	0.75	1	1.5
	mm	08	10	15	20	25	40
L		90	90	103	128	128	142
H app		60	60	70	90	90	112
WT. Kg app		2	2	4	8	8	9.5

## SLUICE GATE VALVE (NON RISING) CLASS - 150

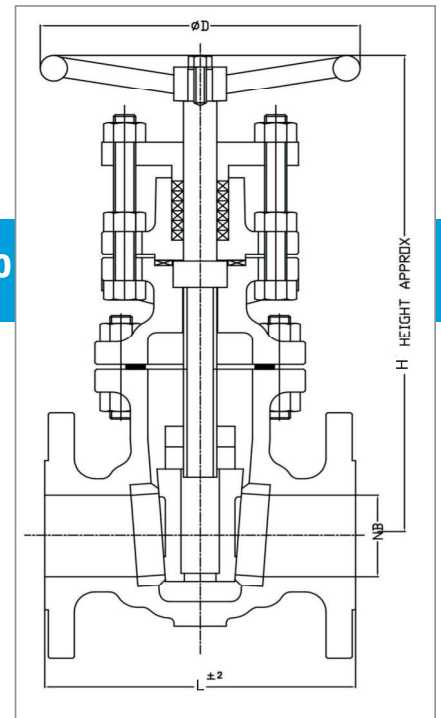

### MATERIAL SPECIFICATION

#### SLUICE VALVES COMPONENTS & SPECIFICATION/GRADE :- IS 14846

Sr. No.	DESCRIPTION	MATERIAL
1	BODY	CAST DUCTILE IRON
2	BONNET	CAST DUCTILE IRON
3	WEDGE	BRONZE
4	SEAT	BRONZE
5	SPINDLE	BRONZE
6	SPINDLE NUT	GUN METAL
7	GLAND	CAST DUCTILE IRON
8	GLAND NUT	ALOY STEEL
9	GLAND BOLT	ALOY STEEL
10	GASKET	SPIRAL WOUND SS 304 WITH GRAPHITE FILLED
11	BONNET STUD & NUT	ALOY STEEL
12	GLAND PACKING	GRAPHITE
13	HAND WHEEL	FABRICATED STEEL
14	HAND WHEEL BOLT	STAINLESS STEEL

\*MOC & TRIMS CAN BE SUPPLIED AS PER CUSTOMER REQUIREMENT.

### DIMENSION TABLE

VALVE SIZE	IN	2	2.5	3	4	5	6	8	10	12
	mm	50	65	80	100	125	150	200	250	300
L		178	191	203	229	254	267	292	330	356
H app		288	307	330	330	457	515	610	790	825
K app		200	200	250	250	250	300	400	400	400
WT. Kg app (F/E)		20	27	34	48	60	77	120	225	270

## BUTTERFLY VALVE-WAFER & FLANGE TYPE BS 5155/AWWA C 504 / MFR. STD

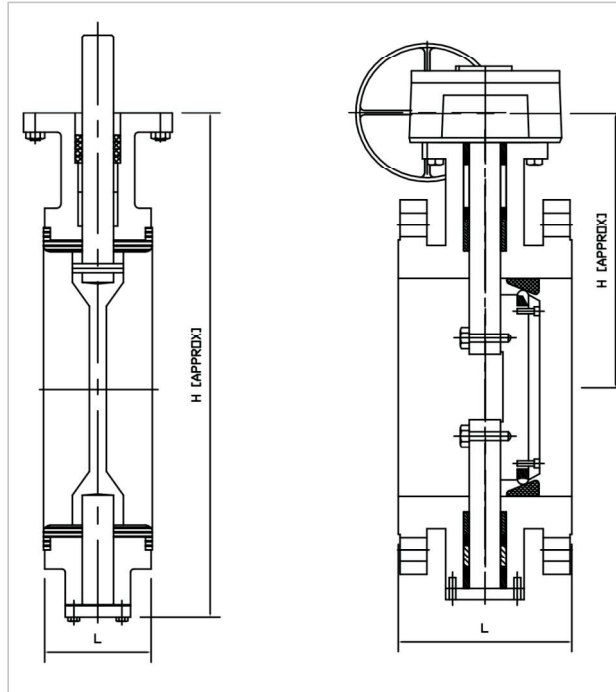

### MATERIAL SPECIFICATION

PARTS	MATERIAL		
BODY	CAST IRON	WCB	CF8/CF8M
DISC	SGI	SS 410/ WCB	SS 304/ SS 316
SEAT	NITRILE / EPDM/ VITON/ TEFLON		
SPINDLE / SHAFT	SS 410	SS 410	SS 304/ SS 316
O' RING	NITRILE / EPDM/ VITON/ TEFLON		
TAPER PIN	SS 410	SS 410	SS 304/ SS 316
PLUG	SS 410		SS 304/ SS 316
BUSH	PTFE		

**DIMENSION TABLE 150#**

**WAFER TYPE**

VALVE SIZE	IN	2	2.5	3	4	5	6	8	10	12	14	16
	mm	50	6.5	80	100	125	150	200	250	300	350	400
L		1.7	1.8	1.8	2.0	2.2	2.4	2.7	3.1	3.1	4.0	4.5
		43	46	46	52	56	56	60	68	78	78	102
H app		113	121	128	146	158	174	196	245	270	288	350
WT. Kg app		6	7	8	11	15	16	26	40	52	56	77

**DIMENSION TABLE 150#**

**FLANGE TYPE**

VALVE SIZE	IN	12	14	16	18	20	24	30	36	40	48	56	64
	mm	300	350	400	450	500	600	750	900	1000	1200	1400	1600
L		8.0	8.0	8.0	8.0	8.0	12.2	12.2	12.2	15.2	15.2	18.2	18.2
		203	203	203	203	203	305	305	305	381	381	457	457
H app		345	375	415	435		705	865	975	1025	1265	1415	1450

# DIAPHRAGM VALVE

BS 5156

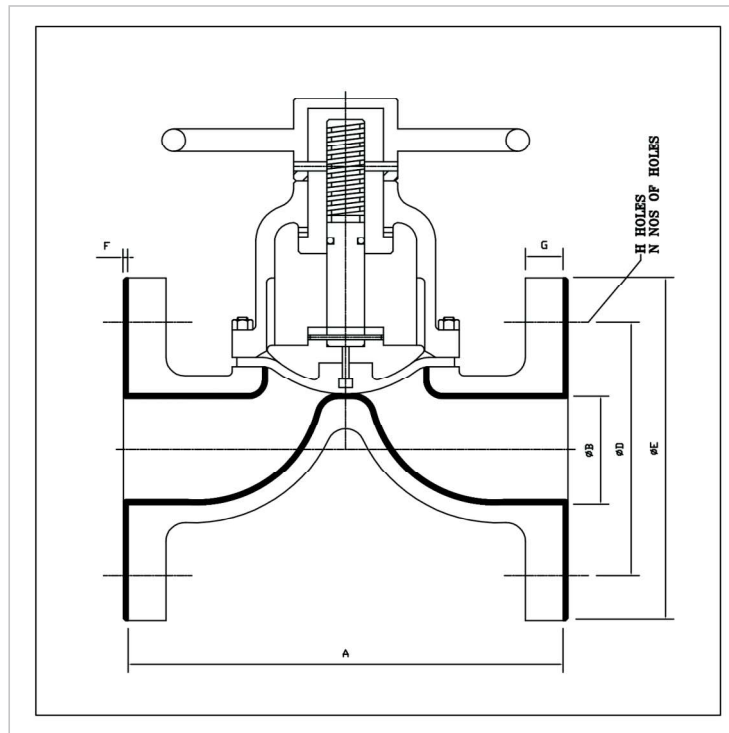

## MATERIAL SPECIFICATION

PARTS	MATERIALS			
	WCB	CF8	CF8M	CI
BODY	WCB	CF8	CF8M	CI
BONNET	WCB	CF8M	CF8M	CI
LINING	EBONITE / EPDM / NR BUTYL / NEOPRENE			
DIAPHRAGM	EPDM / TEFLON			
COMPRESSOR	CARBON STEEL			
SPINDLE	SS410	SS 304	SS 316	SS 410/ SS 304
THURST DISK	PVC			
LOCK PIN	STEEL			
HAND WHEEL	CARBON STEEL			

## DIMENSION TABLE

SIZE	15	20	25	32	40	50	65	80	100	125	150	200
A	108	117	127	146	159	190	216	254	305	356	406	521
B	100	102	150	155	175	200	230	250	325	375	482	550
C	60	60	78	25	175	220	182	227	271	375	375	375
D	65	75	85	100	110	125	145	160	180	210	240	295
E	95	105	115	140	150	165	185	200	220	250	285	340
F	3	3	3	3	3	3	3	4	4	4	4	4
G	14	16	16	18	18	20	20	22	24	26	26	30
H	14	14	14	18	18	18	18	18	18	18	22	22
n	4	4	4	4	4	4	4	8	8	8	8	12

## WAFER TYPE CHECK VALVE

SINGLE PLATE & DUAL PLATE MFR STD / API 6D / API 594

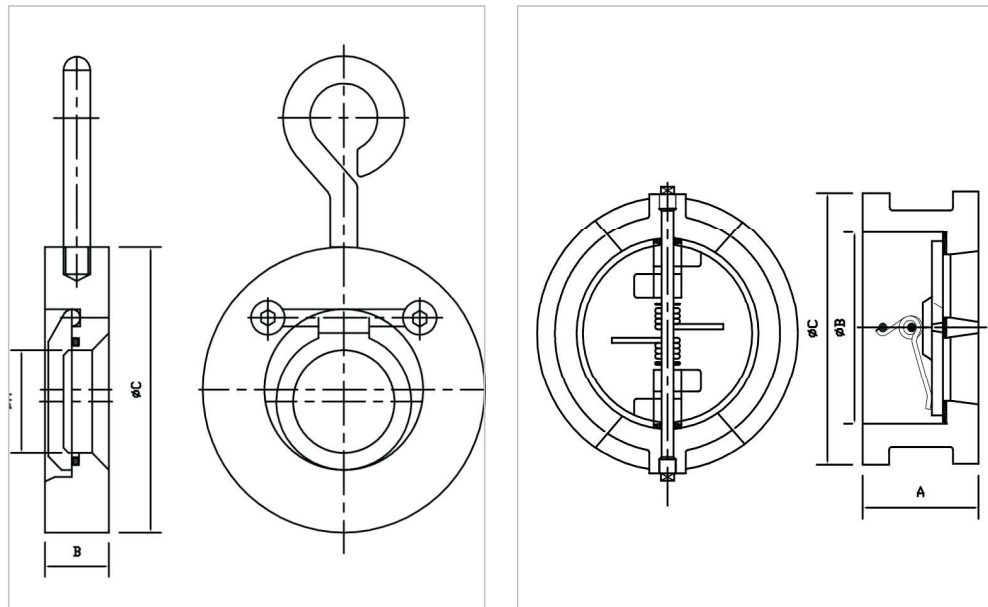

### MATERIAL SPECIFICATION

PARTS	MATERIALS			
	WCB / CS	CF8/SS 304	CF8M/ SS 316	Cl
BODY	WCB / CS	CF8/SS 304	CF8M/ SS 316	Cl
DISC	CS	SS 304	SS 316	SS 410
SEAT RING	NITRILE / EPDM / VITON / TEFLON			
'O' RING	NITRILE / EPDM / VITON / TEFLON			
HINGE PIN	SS 410	SS 304	SS 316	SS 410
HOOK	CS/SS			
SPRING	SS/SPRING STEEL			

### DIMENSION TABLE (SINGLE PLATE)

SIZE	25	40	50	65	100	125	150	200	250	300	350	400	450	500	600
A	14	22	30	40	72	94	114	158	195	230	270	310	360	406	490
B	16	19	19	19	19	19	19	28.5	28.5	38	44.5	51	60.5	63.5	70
C	PN10	72	93	108	128	161	192	219	274	330	380	438	490	538	695
	PN16	72	93	108	128	161	192	219	274	330	380	445	495	555	732
	BS10D	69	86	97	110	161	192	218	274	334	384	445	495	560	727
	BS10E	69	86	97	110	161	192	215	272	331	384	445	495	560	725
	#150	64	86	105	124	174	196	220	278	340	410	450	512	545	715

### DIMENSION TABLE (DUAL-PLATE)

SIZE	50	65	80	100	125	150	200	250
A	60	67	73	73	86	98	127	146
B	70	80	84	114	141	141	219	273
C	105	124	137	175	197	222	279	340

## "Y" TYPE STRAINER CLASS 150

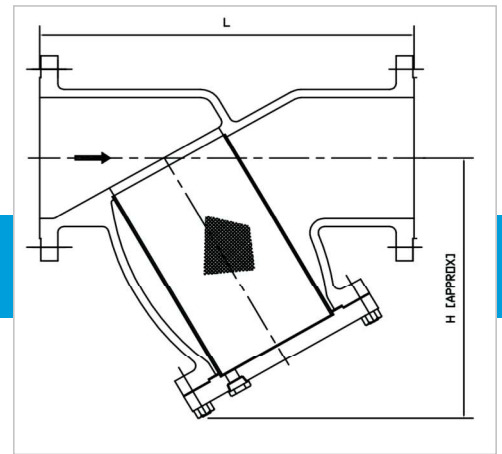

### MATERIAL SPECIFICATION

PARTS	MATERIALS		
BODY	WCB	WC6	CF8/CF8M
COVER	WCB	WC6	CF8/CF8M
SCREEN (MESH)	SS 304/ SS 316		
STUD & NUT	B7/2H		B8/8
DRAIN PLUG	A 105/ SS 304/ SS 316		

### DIMENSION TABLE 150#

VALVE SIZE	IN	1/2	3/4	1	1 1/2	2	2 1/2	3	4	5	6	8	10	12	14
	mm	15	20	25	40	50	65	80	100	125	150	200	250	300	350
L		5.5	6.3	6.7	8.5	9.0	11.4	12.5	15.3	16.9	18.5	23.8	25.5	27.5	31.0
		140	160	170	215	230	290	318	390	430	470	605	650	700	800
H app		100	110	150	160	175	200	250	280	325	360	440	475	515	580
WT. Kg app		3	3.5	5	12	16	22	32	55	90	110	140	200	300	450

## BASKET TYPE STRAINER MFR. STD

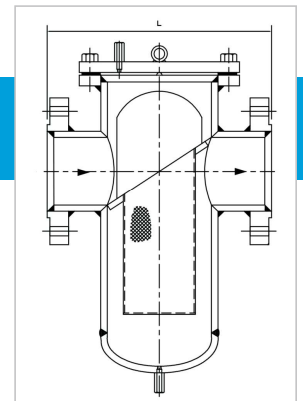

### MATERIAL SPECIFICATION

PARTS	MATERIALS
BODY	C.S.A 106 GR. B
COVER	IS 2062
BOTTOM PLATE	IS 2062
SCREEN (MESH)	SS 304/ SS 316
SCREEN FRAME	IS 2002 GR. 2A/ S2062
GUIDE RING	CS/IS 2002 GR. 2A/ IS2062
SCREEN HANDLE	C.S
GASKET	SPW SS 304/ SS 316 GRAFOIL FILLER
STUD & NUT	B7/2H

### DIMENSION TABLE 150#

VALVE SIZE	IN	1	1 1/2	2	3	4	5	6	8	10	12	14	16	20	24
	mm	25	40	50	80	100	125	150	200	225	300	350	400	500	600
L		6.4	8.0	9.2	12.4	14.0	17.8	22.4	24.0	29.2	31.2	33.6	36.0	38.0	44.8
		160	200	230	310	150	445	560	600	730	780	840	900	950	1120
H app		340	430	450	554	680	879	1000	1150	1210	1230	1390	1560	1720	2050

## FLANGE DIMENSIONS

ASME B 16.5

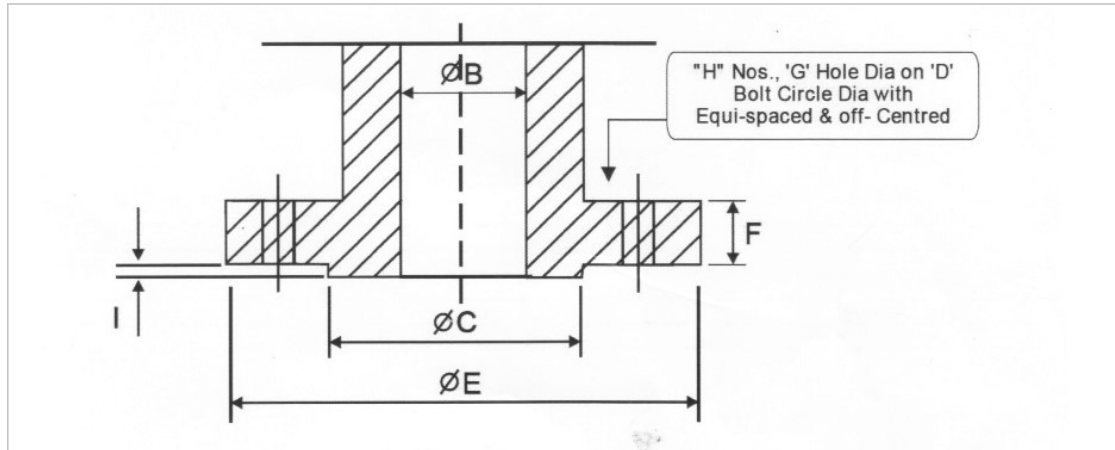

## MATERIAL SPECIFICATION

### END FLANGE DETAILS (ASME B 16.5)

DETAILS	DISCRIPTION	NOMINAL VALVES SIZES IN mm (INCHES)																		
		25 (1")	32 (1¼")	40 (1½")	50 (2)	65 (2½")	80 (3")	100 (4")	125 (5")	150 (6")	200 (8")	250 (10")	300 (12")	350 (14")	400 (16")	450 (18")	500 (20")	600 (24")		
B	BORE DIA	150	110	115	125	150	180	190	230	255	280	345	405	485	535	595	635	700	815	
		300	125	135	156	165	191	210	255	280	320	380	445	520	585	650	710	775	915	
		600	125	135	155	165	191	210	275	330	356	420	508	560	605	686	745	815	940	
E	FLANGE DIA	150	10	11.5	13	14.5	16	17.5	22.5	22.5	24	27	29	30.5	33.5	35	38.5	41.5	46.5	
		300	16	17.5	19.5	21	24	27	30.5	33.5	35	40	46.5	49.5	52.5	55.5	59	62	68.5	
		600	17.5	21	22.5	25.5	29	32	38.5	44.5	48	56	63.5	67	70	76.5	83	89	102	
F	FLANGE THICK	150	51	64	73	92	105	127	157	186	216	270	324	381	413	470	533	584	692	
		300	51	64	73	92	105	127	157	186	216	270	324	381	413	470	533	584	692	
		600	51	64	73	92	105	127	157	186	216	270	324	381	413	470	533	584	692	
C	RF. DIA	150	79	89	99	121	140	152	191	216	241	298	362	432	476	540	578	635	749	
		300	89	89	114	127	149	168	200	235	270	330	387	451	514	572	629	686	813	
		600	89	99	114	127	149	168	216	267	292	349	432	489	527	603	654	724	838	
D	BOLT CIRCLE DIA	150	16	16	16	19	19	19	19	22	22	22	25	25	29	29	32	32	35	
		300	19	19	22	19	22	22	22	22	22	25	25	32	32	35	35	35	41	
		600	19	19	22	19	22	22	25	29	29	32	35	35	38	41	45	45	51	
G	HOLE DIA	150	4	4	4	4	4	4	8	8	8	8	12	12	12	16	16	20	20	
		300	4	4	4	8	8	8	8	8	8	12	12	16	16	20	20	24	24	24
		600	4	4	4	8	8	8	8	8	8	12	12	16	20	20	20	20	24	24
H	NUMBER OF HOLE	150	2	2	2	2	2	2	2	2	2	2	2	2	2	2	2	2	2	
		300	2	2	2	2	2	2	2	2	2	2	2	2	2	2	2	2	2	
		600	7	7	7	7	7	7	7	7	7	7	7	7	7	7	7	7	7	
I	RF RIGHT	150	2	2	2	2	2	2	2	2	2	2	2	2	2	2	2	2	2	
		300	2	2	2	2	2	2	2	2	2	2	2	2	2	2	2	2	2	
		600	7	7	7	7	7	7	7	7	7	7	7	7	7	7	7	7	7	

## BUTT WELD END DIMENSIONS

ASME B 16.5

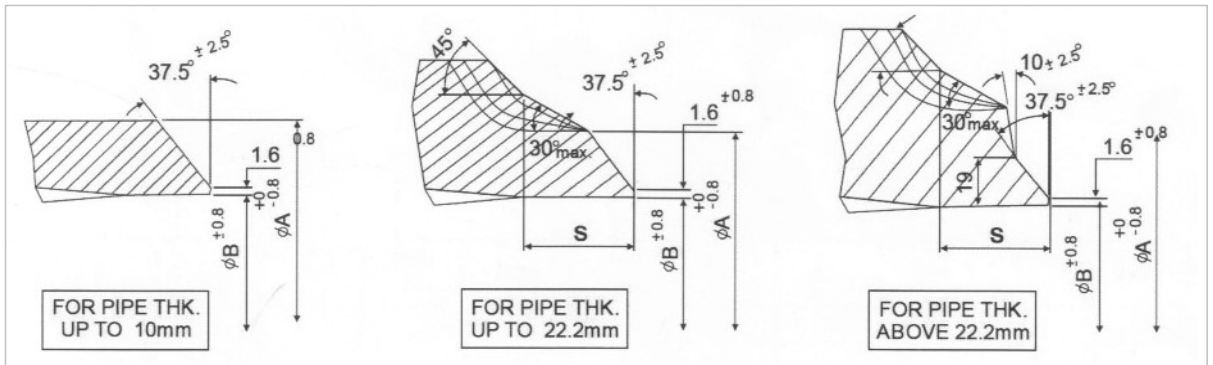

PIPE SIZE	SCH.	PIPE O.D	φA	φB	S	PIPE SIZE	SCH.	PIPE O.D	φA	φB	S
1"	40	33.4	35	26.59	5.124.4	2.5"	40	73.0	75	62.6	7.8
	60						60				
	80			24.4	6.75		80			59	10.5
	100						100				
	120						120				
	140						140				
	160			20.7	9.52		160			54	14.25
	XXS			15.2	13.65		XXS			45	21
1.25"	40	42.4	44	35.0	5.4	3"	40	88.9	91.2	77.93	8.23
	60						60				
	80			32.4	7.35		80			73.66	11.43
	100						100				
	120						120				
	140						140				
	160			29.5	9.52		160			66.65	16.68
	XXS			22.78	14.55		XXS			58.42	22.86
1.5"	40	48.3	50	40.9	5.55	4"	40	114.3	117.4	102.26	9.03
	60						60				
	80			38.1	7.65		80			97.18	12.84
	100						100				
	120						120			92.05	16.68
	140						140				
	160			34.0	10.72		160			87.33	20.23
	XXS			27.9	15.3		XXS			80.06	25.68
2"	40	60.3	62	52.5	5.85	5"	40	141.2	144.5	128.19	10
	60						60				
	80			49.3	8.25		80			122.25	14.2
	100						100				
	120						120			115.9	19
	140						140				
	160			42.9	13.05		160			109.55	23.81
	XXS			38.1	16.65		XXS			103.2	28.57

## BUTT WELD END DIMENSIONS

ASME B 16.25

PIPE SIZE	SCH.	PIPE O.D	φA	φB	S	PIPE SIZE	SCH.	PIPE O.D	φA	φB	S
6"	40	168.3	172.2	154.05	10.66	16"	40	406.4	413	381	19.05
	60						60			373.08	24.99
	80			146.33	16.45		80			363.58	32.11
	100						100			354.03	39.28
	120			139.73	21.40		120			344.47	46.44
	140						140			333.35	54.78
	160			131.80	27.36		160			325.42	60.73
	XXS			124.38	32.91		XXS				
8"	40	219.1	223	202.72	12.27	18"	40	457.2	464.3	428.65	21.4
	60			198.45	15.46		60			419.1	28.57
	80			193.67	19.05		80			409.6	35.7
	100			188.89	22.63		100			398.48	44.04
	120			182.6	27.36		120			387.35	52.38
	140			177.83	30.93		140			377.85	59.5
	160			173.05	34.51		160			366.73	67.86
	XXS			174.62	33.33		XXS			431.8	19.05
10"	40	273	278	254.51	13.90	20"	40	508	516	477.88	22.63
	60			247.65	19.05		60			466.75	30.93
	80			242.87	22.63		80			455.63	39.28
	100			236.52	27.36		100			442.93	48.81
	120			230.17	32.11		120			431.8	57.15
	140			222.2	38.1		140			419.1	66.67
	160			215.90	42.85		160			407.97	74.98
	XXS						XXS			482.6	19.05
12"	40	323.8	329	303.23	15.46	22"	40	559	567.4		
	60			295.3	21.40		60			514.35	33.33
	80			288.95	26.17		80			501.65	42.86
	100			280.97	32.11		100			488.95	52.38
	120			273.05	38.1		120			476.25	61.9
	140			266.7	42.85		140			463.55	71.43
	160			257.2	49.98		160			450.85	80.96
	XXS			298.45	19.05		XXS			533.4	19.05
14"	40	355.6	362	333.35	16.68	24"	40	610	619	574.7	26.17
	60			325.42	22.63		60			560.37	36.88
	80			317.5	28.5		80			547.67	46.44
	100			308	35.7		100			531.83	58.33
	120			300.02	41.68		120			517.55	69.03
	140			292.1	47.62		140			504.85	78.55
	160			284.18	53.56		160			490.52	89.26
	XXS			330.2	19.05		XXS			584.2	19.05

## DIMENSION OF RING JOINT

ASME B 16.5

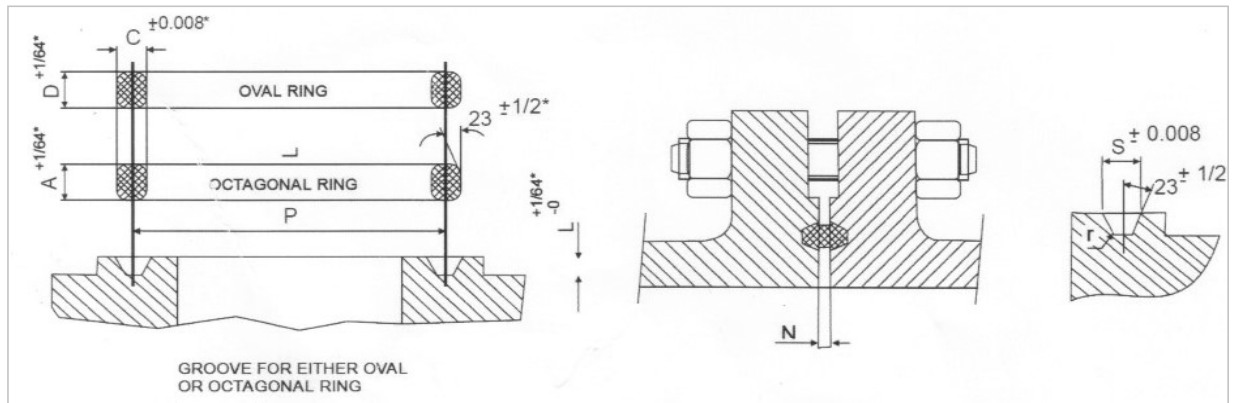

Ring No.	P		S		L		r max.		A		C		D		N	
	mm	inches	mm	inches	mm	inches	mm	inches	mm	inches	mm	inches	mm	inches	mm	inches
R11	34.1	1 11/32	7.1	9/32	5.5	7/32	1	1/32	9.5	3/8	6.4	1/4	11.1	7/16	3.2	3.2
R12	39.7	1 9/16	8.7	11/32	6.3	1/4	1	1/32	12.7	1/2	7.9	5/16	14.3	9/16	4	4
R13	42.9	1 11/16	8.7	11/32	6.3	1/4	1	1/32	12.7	1/2	7.9	5/16	14.3	9/16	3.9	3.9
R14	44.4	1 3/4	8.7	11/32	6.3	1/4	1	1/32	12.7	1/2	7.9	5/16	14.3	9/16	4	4
R15	47.6	1 7/8	8.7	11/32	6.3	1/4	1	1/32	12.7	1/2	7.9	5/16	14.3	9/16	4	4
R16	50.8	2	8.7	11/32	6.3	1/4	1	1/32	12.7	1/2	7.9	5/16	14.3	9/16	3.9	3.9
R17	57.1	2 1/4	8.7	11/32	6.3	1/4	1	1/32	12.7	1/2	7.9	5/16	14.3	9/16	4	4
R18	60.3	2 3/8	8.7	11/32	6.3	1/4	1	1/32	12.7	1/2	7.9	5/16	14.3	9/16	3.9	3.9
R19	65.1	2 9/16	8.7	11/32	6.3	1/4	1	1/32	12.7	1/2	7.9	5/16	14.3	9/16	4	4
R20	68.3	2 11/16	8.7	11/32	6.3	1/4	1	1/32	12.7	1/2	7.9	5/16	14.3	9/16	3.9	3.9
R21	72.2	2 27/32	11.9	15/32	7.9	5/16	1	1/32	15.9	5/8	11.1	7/16	17.5	11/16	4	4
R22	82.5	3 1/4	8.7	11/32	6.3	1/4	1	1/32	12.7	1/2	7.9	5/16	14.3	9/16	4	4
R23	82.5	3 1/4	11.9	15/32	7.9	5/16	1	1/32	15.9	5/8	11.1	7/16	17.4	11/16	5.9	4.8
R24	95.2	3 3/4	11.9	15/32	7.9	5/16	1	1/32	15.9	5/8	11.1	7/16	17.5	11/16	3.2	3.2
R25	101.6	4	8.7	11/32	6.3	1/4	1	1/32	12.7	1/2	7.9	5/16	14.3	9/16	4	4
R26	101.6	4	11.9	15/32	7.9	5/16	1	1/32	15.9	5/8	11.1	7/16	17.4	11/16	5.5	4.8
R27	107.9	1 1/4	11.9	15/32	7.9	5/16	1	1/32	15.9	5/8	11.1	7/16	17.5	11/16	3.2	3.2
R28	111.1	4 3/8	13.5	17/32	9.5	3/8	1.5	1/16	17.5	11/16	12.7	1/2	19.1	3/4	3.2	3.2
R29	114.3	4 1/2	8.7	11/32	6.3	1/4	1	1/32	12.7	1/2	7.9	5/16	14.3	9/16	4	4
R30	117.5	4 5/8	8.7	15/32	7.9	5/16	1	1/32	15.9	5/8	12.7	1/2	7.9	5/16	4	4
R31	123.8	4 7/8	11.9	15/32	7.9	5/16	1	1/32	15.9	5/8	11.1	7/16	17.4	11/16	5.5	4.8
R32	127	5	11.9	17/32	9.5	3/8	1.5	1/16	17.5	5/8	12.7	1/2	19.1	3/4	3.2	3.2
R33	131.8	5 3/16	13.5	11/32	6.3	1/4	1	1/32	12.7	1/2	7.9	5/16	14.3	9/16	4	4
R34	131.8	5 3/16	8.7	15/32	7.9	5/16	1	1/32	15.9	5/8	11.1	7/16	17.4	11/16	5.5	4.8
R35	136.5	5 3/8	11.9	15/32	7.9	5/16	1	1/32	15.9	5/8	11.1	7/16	17.5	11/16	3.2	3.2
R36	149.2	5 7/8	11.9	11/32	6.3	1/4	1	1/32	12.7	1/2	7.9	5/16	14.3	9/16	4	4
R37	149.2	5 7/8	8.7	15/32	7.9	5/16	1	1/32	15.9	5/8	11.1	7/16	17.5	11/16	4	4
R38	157.1	6 3/16	11.9	21/32	11.1	7/16	1.5	1/16	20.6	3/16	15.9	5/8	22.2	7/8	4	4
R39	161.9	6 3/8	16.7	15/32	7.9	5/16	1	1/32	15.9	5/8	11.1	7/16	17.5	11/16	3.2	3.2
R40	171.4	6 3/4	11.9	11/32	6.3	1/4	1	1/32	12.7	1/2	7.9	5/16	14.3	9/16	4	4
R41	181	7 1/8	8.7	15/32	7.9	5/16	1	1/32	15.9	5/8	11.1	7/16	17.4	11/16	5.5	4.8
R42	190.5	7 1/2	11.9	52/32	12.7	1/2	1.5	1/16	23.8	15/16	19.1	3/4	25.4	1	4	4
R43	193.7	7 5/8	19.8	11/32	6.3	1/4	1	1/32	12.7	1/2	7.9	5/16	14.3	9/16	4	4
R44	193.7	7 5/8	8.7	15/32	7.9	5/16	1	1/32	15.9	5/16	11.1	7/16	17.5	11/16	3.2	3.2
R45	211.1	8 5/16	11.9	15/32	7.9	5/16	1	1/32	15.9	5/16	11.1	7/16	17.5	11/16	4	4
R46	211.1	8 5/16	13.5	17/32	9.5	3/8	1.5	1/16	17.5	11/16	12.7	1/2	19.1	3/4	3.2	3.2

## DIMENSION OF RING JOINT

### ASME B 16.5

Ring No.	P		S		L		r max.		A		C		D		N	
	mm	inches	mm	inches	mm	inches	mm	inches	mm	inches	mm	inches	mm	inches	300#	600#
R47	228.6	9	19.8	25/32	12.7	2/1	1.5	1/16	23.8	15/16	191	3/4	25.4	1	4	4
R48	247.6	9 3/4	8.7	11/32	6.3	4/1	1	1/32	12.7	1/2	7.9	5/16	14.3	9/16	4	4
R49	269.9	10 5/8	11.9	25/32	7.9	5/16	1	1/32	15.9	5/8	11.1	7/16	17.5	11/16	5.5	4.8
R50	269.9	10 5/8	16.7	21/32	11.1	7/16	1.5	1/16	20.6	13/16	15.9	5/8	22.2	7/8	4	4
R51	279.4	11	23	29/32	14.3	9/16	1.5	1/16	27	1 1/16	22.2	7/8	28.6	1 1/8	4.8	4.8
R52	304.8	12	8.7	11/32	6.3	1/4	1	1/32	12.7	1/2	7.9	5/16	14.3	9/16	4	4
R53	323.8	12 3/4	11.9	15/32	7.9	5/16	1	1/32	15.9	5/8	11.1	7/16	17.4	11/16	5.5	4.8
R54	323.8	12 3/4	16.7	21/32	11.1	7/16	1.5	1/16	20.6	13/16	15.9	5/8	22.2	7/8	4	4
R55	342.9	13 1/2	30.2	13/16	17.4	11/16	2.5	3/32	34.9	13/8	28.6	1 1/8	36.5	1 7/16	6.4	6.4
R56	381	15	8.7	11/32	6.3	1/4	1	1/32	12.7	1/2	7.9	5/16	14.3	9/16	4	4
R57	381	15	11.9	15/32	7.9	5/16	1	1/32	15.9	5/8	11.1	7/16	17.4	11/16	5.5	4.8
R58	381	15	23	29/32	14.3	9/16	1.5	1/16	27	1 1/16	22.2	7/8	28.6	1 1/8	4.8	4.8
R59	396.9	15 3/8	8.7	11/32	6.3	1/4	1	1/32	12.7	1/2	7.9	5/16	14.3	9/16	3.2	3.2
R60	406.4	16	33.3	15/16	17.4	11/16	2.5	3/32	38.1	1 1/2	31.8	1 1/4	39.7	1 9/16	7.9	7.9
R61	419.1	16 1/2	11.9	15/32	7.9	5/16	1	1/32	15.9	5/8	11.1	7/16	17.4	11/16	5.5	4.8
R62	419.1	16 1/2	16.7	21/32	11.1	7/16	1.5	1/16	20.6	13/16	15.9	5/16	22.2	7/8	4	4
R63	419.1	16 1/2	27	11/16	15.9	5/8	2.5	3/32	31.8	1 1/4	25.4	1	33.3	1 5/16	5.5	5.5
R64	454	17 7/8	8.7	11/32	6.3	1/4	1	1/32	12.7	1/2	7.9	5/16	14.3	9/16	3.2	3.2
R65	469.9	18 1/2	11.9	15/32	7.9	5/16	1	1/32	15.9	5/8	11.1	7/16	17.4	11/16	5.5	5.5
R66	469.9	18 1/2	16.7	21/32	11.1	7/16	1.5	1/16	20.6	13/16	15.9	5/8	22.2	7/8	4	4
R67	469.9	18 1/2	30.2	13/16	17.4	11/16	2.5	3/32	34.9	1 3/8	28.6	1 1/8	36.5	1 7/16	7.9	7.9
R68	517.5	20 3/8	8.7	11/32	6.3	1/4	1	1/32	12.7	1/2	7.9	5/16	14.3	9/16	3.2	3.2
R69	533.4	21	11.9	15/32	7.9	5/16	1	1/32	15.9	5/8	11.1	7/16	17.4	11/16	5.5	4.8
R70	533.4	21	19.8	25/32	12.7	1/2	1.5	1/16	23.8	15/16	19.1	3/4	25.4	1	4.8	4.8
R71	533.4	21	30.2	13/16	17.4	11/16	2.5	3/32	34.9	1 3/8	28.6	1 1/8	36.5	1 7/16	7.9	7.9
R72	558.8	22	8.7	11/32	6.3	1/4	1	1/32	12.7	1/2	7.9	5/16	14.3	9/16	3.2	3.2
R73	584.2	23	13.5	17/32	9.5	3/8	1.5	1/16	17.4	5/8	12.7	1/2	19.1	3/4	5.5	4.8
R74	584.2	23	19.8	25/32	12.7	1/2	1.5	1/16	23.8	15/16	19.1	3/4	25.4	1	4.8	4.8
R75	584.2	23	33.3	15/16	17.4	11/16	2.5	3/32	38.1	1 1/2	39.8	1 1/4	39.7	1 9/16	9.5	9.5
R76	673.1	26 1/2	8.7	11/32	6.3	1/4	1	1/32	12.7	1/2	7.9	5/16	14.3	9/16	3.2	3.2
R77	692.1	27 1/4	16.7	21/32	11.1	7/16	1.5	1/16	20.6	13/16	15.9	5/8	22.2	7/8	6.4	5.5
R78	692.1	27 1/4	27	11/16	15.9	5/8	2.5	3/32	31.8	1 1/4	25.4	1	33.3	1 5/16	5.5	5.5
R79	692.1	27 1/4	36.5	17/16	20.6	13/16	2.5	3/32	41.3	1 5/8	34.9	1 3/8	44.5	1 3/4	11.1	11.1

## ASTM MATERIALS

ASTM Code	Chemical Compositions %											Mechanical		
	C	Mn	P	S	Si	Cr	Mo	Ni	Cu	V	Tensile Mpa	Yield Mpa	% Elongation	% Reduct Area
	max.	max.	max.	max.	max.	max.	max.	max.	max.	max.	min.	min.	min.	min.
A216 WCB	0.30	1.00	0.040	0.045	0.60	0.50	0.20	0.50	0.30	0.03	485	250	22	35
A216 WCC	0.25	0.25	0.040	0.045	0.60	0.50	0.20	0.50	0.30	0.03	485	275	22	35
A217 WC1	0.25	0.25	0.040	0.045	0.60		0.65		0.50		450	240	24	35
A217 WC5	0.05 0.20	0.05 0.20	0.040	0.045	0.60	0.50 0.90	0.90 1.20	0.60 1.00	0.50	0.10 tu	485 to 655	275	20	35
A217 WC6	0.20	0.20	0.040	0.045	0.60	1.50	0.65		0.50		485	275	20	35
A217 WC9	0.18	0.18	0.040	0.045	0.60	2.75	1.20		0.50		485	275	20	35
A217 C5	0.20	0.20	0.040	0.045	0.75	6.50	0.65		0.50		620	415	18	35
A217 CA15	0.15	0.15	0.040	0.040	1.50	14.00	0.50	1.00			620	450	18	30
A351CF8	0.08	0.08	0.040	0.040	2.00	21.00	0.50	11.00			485	205	35	
A351 CF8M	0.08	0.08	0.040	0.040	1.50	21.00	3.00	12.00			485	205	30	
A351 CF3	0.03	0.03	0.040	0.040	2.00	21.00	0.50	12.00			485	205	35	
A351 CF3M	0.03	0.03	0.040	0.040	1.50	21.00	3.00	13.00			485	205	30	
A351CN7M	0.07	0.07	0.040	0.040	1.50	22.00	3.00	30.50	4.0		425	170	35	
A352 LCB	0.30	0.30	0.040	0.045	0.60	0.50	0.20	0.50	0.30	0.03	450	240	24	35
A352 LCC	0.25	0.25	0.040	0.045	0.60	0.50	0.20	0.50	0.30	0.03	485	275	22	35
A105	0.35	0.35	0.035	0.040	0.35	0.30	0.12	0.40	0.40	0.05	485	250	30	30
A182 F304	0.08	0.08	0.040	0.030	1.00	20.00		11.00			515	205	30	50
A182 F316	0.08	0.08	0.040	0.030	1.00	18.00	18.00	14.00			515	205	30	50
A182 F304L	0.04	0.04	0.040	0.030	1.00	20.00	20.00	13.00			485	170	30	50
A182 F316L	0.04	0.04	0.040	0.030	1.00	18.00		15.00			485	170	30	50
A182F5	0.15	0.15	0.030	0.030	0.500	4.00 6.00		0.50			485	275	20	35
A182 F11C1	0.05 0.15	0.05 0.15	0.030	0.030	0.50 1.00	1.00 1.50					415	205	20	45
A182F11C2	0.10	0.10	0.040	0.040	0.50	1.00					485	276	20	30
182F11C3	0.20	0.20	0.040	0.040	1.00	1.50					515	310	20	30
A182F22C1	0.05 0.15	0.05 0.15	0.040	0.040	0.50	2.00 2.50					415	205	20	35
A182 F22C2	0.15 0.16	0.15 0.16	0.040	0.040	0.50	2.00 2.51	515				515	310	20	30
A350 LF2	0.03	0.03	0.035	0.035	0.15 0.30	0.30	485 to 655	0.40	0.40	0.02 0.03	485 to 655	250	30	197
A276 410	0.15	0.15	0.040	0.030	1.00	11.5 13.5	690				690	550	15	45
A276 420	0.15	1.00	0.040	0.040	1.00	14.00								
A193 B7	0.49	1.10	0.035	0.035	0.35	1.20	860				860	720	16	50
A193 B7M	0.49	1.10	0.035	0.035	0.35	1.20	690				690	550	18	50
A193 B8	0.08	2.00	0.045	0.045	1.00	20.00	515	10.50			515	205	30	50
A193 B8M	0.08	2.00	0.045	0.045	1.00	18.00	515	14.00			515	205	30	50
A194 2H	0.40	1.00	0.040	0.040	0.40									
A194 2HM	0.40	1.00	0.040	0.040	0.40									
A320 L7	0.48	1.00	0.035	0.035	0.35	1.10	860				860	725	16	50
A320 L7M	0.48	1.00	0.035	0.035	0.35	1.10	690				690	550	18	50
A194 8	0.08	2.00	0.045	0.045	1.00	20.00		10.50						

**PRESSURE - TEMPERATURE RATINGS**  
AS PER ASME B 16.34

		A 351 Gr. CF3, CF8			A 351 Gr. CF3M, CF8M			A 351 Gr. CN7M		
Temp. °C		Working Pressure by Class, Bar								
		150	300	600	150	300	600	150	300	600
-29 to 38		19	49.6	99.3	19	49.6	99.3	15.9	41.4	82.7
50		18.3	47.8	95.6	18.4	48.1	96.2	15.4	40.1	80.3
100		15.7	40.9	81.7	16.2	42.2	84.4	13.5	35.3	70.6
150		14.2	37	74	14.8	38.5	77	12.3	32	64.1
200		13.2	34.5	69	13.7	35.7	71.3	11.3	29.4	58.7
250		12.1	32.5	65	12.1	33.4	66.8	10.4	27.2	54.4
300		10.2	30.9	61.8	10.2	31.6	63.2	9.7	25.4	50.8
325		9.3	30.2	60.4	9.3	30.9	61.8	9.3	24.4	48.8
350		8.4	29.6	59.3	8.4	30.3	60.7	...NA...	...NA...	...NA...
375		7.4	29	58.1	7.4	29.9	59.8	...NA...	...NA...	...NA...
400		6.5	28.4	56.9	6.5	29.4	58.9	...NA...	...NA...	...NA...
425		5.5	28	56	5.5	29.1	58.3	...NA...	...NA...	...NA...
450		4.6	27.4	54.8	4.6	28.8	57.7	...NA...	...NA...	...NA...
475		3.7	26.9	53.9	3.7	28.7	57.3	...NA...	...NA...	...NA...
500		2.8	26.5	53	2.8	28.2	56.5	...NA...	...NA...	...NA...
538		1.4	24.4	48.9	1.4	25.2	50	...NA...	...NA...	...NA...
Hydrostatic Shell Test Pressure		28.5	74.4	148.95	28.5	74.4	148.95	23.85	62.1	124.05
		(415)	(1080)	(2160)	(415)	(1080)	(2160)	(350)	(905)	(1800)
Valve Closure Test Pressure	HYDRO	209	54.56	109.23	20.9	54.56	109.23	17.49	45.54	90.97
	AIR	(305)	(795)	(1585)	(305)	(795)	(1585)	(255)	(665)	(1320)
					5.5					
					(80)					

NOTE : (1) Not to be used over 425°C for CF3 (2) Not to be used over 455°C for CF3 M (3) Not to be used over 538°C for CF8 & CF8 M

		A 26 Gr. WCB			A 352 Gr. LCB			A 217 Gr. C5		
Temp. °C		Working Pressure by Class, Bar								
		150	300	600	150	300	600	150	300	600
-29 to 38		19.6	51.1	102.1	18.4	48	96	20	51.7	103.4
50		19.2	50.1	100.2	18.2	47.5	94.9	19.5	51.7	103.4
100		17.7	46.6	93.2	17.4	45.3	90.7	17.7	51.5	103
150		15.8	45.1	90.2	15.8	43.9	87.9	15.8	50.3	100.3
200		13.8	43.8	87.6	13.8	42.5	85.1	13.8	48.6	97.2
250		12.1	41.9	83.9	12.1	40.8	81.6	12.1	46.3	92.7
300		10.2	39.8	79.6	10.2	38.7	77.4	10.2	42.9	85.7
325		9.3	38.7	77.4	9.3	37.6	75.2	9.3	41.4	82.6
350		8.4	37.7	75.1	8.4	36.4	72.8	8.4	40.3	80.4
375		7.4	36.4	72.7	...NA...	...NA...	...NA...	7.4	38.9	77.6
400		6.5	34.7	69.4	...NA...	...NA...	...NA...	6.5	36.5	73.3
425		5.5	28.8	57.5	...NA...	...NA...	...NA...	5.5	35.2	70
450		...NA...	...NA...	...NA...	...NA...	...NA...	...NA...	4.6	32.7	67.7
475		...NA...	...NA...	...NA...	...NA...	...NA...	...NA...	3.7	27.9	55.7
500		...NA...	...NA...	...NA...	...NA...	...NA...	...NA...	2.8	21.4	42.8
538		...NA...	...NA...	...NA...	...NA...	...NA...	...NA...	1.4	13.7	27.4
Hydrostatic Shell Test Pressure		29.4	76.65	153.15	27.6	72	144	30	77.55	155.1
		(430)	(1115)	(2225)	(405)	(1045)	(2090)	(435)	(1125)	(2250)
Valve Closure Test Pressure	HYDRO	21.56	56.21	112.31	20.24	54.8	105.6	22	56.87	113.74
	AIR	(315)	(820)	(1630)	(295)	(770)	(1535)	(320)	(825)	(1650)
					5.5					
					(80)					

NOTE : 1) 1 bar = 14.5 psig, ( ) = psig

# FLANGES AND FORGED FITTINGS

## FLANGES

**Stainless Steel:** ASTM A 182, A 240

**Grade:** F 304, 304L, 304H, 316, 316L, 316Ti, 310, 310S, 321, 321H, 317, 347, 347H  
ASTM A 105, ASTM A 181

**Alloy Steel:** ASTM A 182, GR F1, F11, F22, F5, F9, F91

**Nickel Alloys:** Monel 400 & 500, Inconel 600 & 625, Incolloy 800, 825, Hastelloy 904

**Duplex Steel**

**Grade:** 2205 (UNS No. S31803), 2207 (UNS No. S32760)

**Nickel Alloy**

**Grade:**

Nickel 200 (UNS No. N02200), Nickel 201 (UNS No. N02201),  
Monel 400 (UNS No. N04400), Monel 500 (UNS No. N05500),  
Inconel 800 (UNS No. N08800), Inconel 825 (UNS No. N08825),  
Inconel 600 (UNS No. N06600), Inconel 625 (UNS No. N06625),  
Inconel 601 (UNS No. N06601),  
Hastelloy C 276 (UNS No. N10276),  
Alloy 20 (UNS No. N08020),  
Titanium (Grade I & II)

**Copper Alloy**

**Grade:**

UNS No. C 10100, 10200, 10300, 10800, 12000, 12200, 70600, 71500,  
UNS No. C 70600 (Cu -Ni- 90/10), C 71500 (Cu -Ni- 70/30)

**Types :** Weldneck, Slipon, Blind, Socket Weld, Lap Joint, Spectacles, Ring joint,  
Orifcase, Long Weldneck, Deck Flange, etc.

**Size :** 1/8" NB TO 48"NB.

**Class :** 150#, 300#,400 #,600#,900#, 1500# & 2500 #.

\* Annealed/Solution Annealed.

\* Hardened & Tempered.

\* Strain Hardened.

\* Centerless Ground.

\* Centerless Ground & Polished.

\* Cold Drawn.

\* Smooth Turned & Polished.

\* Forged & Rough Turned.

\* Buffed (Mirror finish).

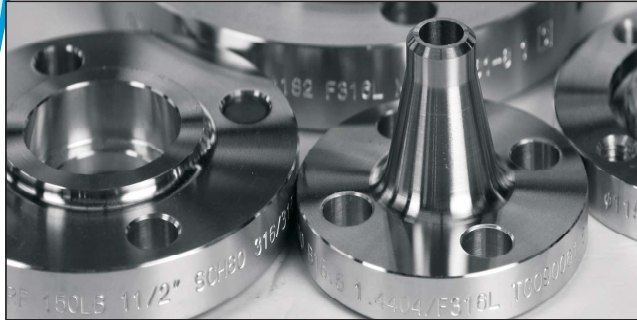

## FORGED FITTINGS

**Stainless Steel:** ASTM A 182

**Grade:** F 304, 304L, 304H, 316, 316L, 316Ti, 310, 310S, 321, 321H, 317, 347, 347H

**Duplex Steel**

**Grade:** 2205 (UNS No. S31803), 2207 (UNS No. S32760)

**Carbon Steel:** ASTM A 105, A187

**Alloy Steel:** ASTM A 182, Grade F1, F11, F22, F5, F9, F91

**Nickel Alloys:**

Nickel 200 (UNS No. N02200), Nickel 201 (UNS No. N02201),  
Monel 400 (UNS No. N04400), Monel 500 (UNS No. N05500),  
Inconel 800 (UNS No. N08800), Inconel 825 (UNS No. N08825),  
Inconel 600 (UNS No. N06600), Inconel 625 (UNS No. N06625),  
Inconel 601 (UNS No. N06601),  
Hastelloy C 276 (UNS No. N10276),  
Alloy 20 (UNS No. N08020),  
Titanium (Grade I & II)

**Copper Alloy**

**Grade:**

UNS No. C 10100, 10200, 10300, 10800, 12000, 12200, 70600, 71500,  
UNS No. C 70600 (Cu -Ni- 90/10), C 71500 (Cu -Ni- 70/30)

**Types :** Elbow, Tee, Union, Cross, Coupling, Cap, Bushing, Plug, Swage Nipple,  
Welding Boss, Hexagon Nipple, Barrel Nipple, Welding Nipple, Parallel Nipple,  
Street Elbow, Hexagon Nut, Hose Nipple, Bend, Adapter, Insert, Weldolet,  
Elbowlet, Sockolet, Thredolet, Nipolet, Letrolet, etc.

**Size :** 1/8"NB TO 4"NB (Socketweld & Threaded)



## COMPANY INFRASTRUCTURE & TESTING FACILITIES



Lifting Facility



Lapping Facility



Assembly



Office Area



Valve Thickness Testing



Hardness Testing



Finished Valves

### Major Clientele and Approval

- Adani Power
- Aker Solutions
- APGENCO / TSGENCO
- BGR Energy Ltd.
- Bharat Pumps & Compressor Ltd.
- Dodsai Pvt. Ltd.
- Econosto Mideast BV
- Essar Project (India) Ltd.
- Gas Authority of India Ltd.
- Gujarat Narmada Valley Fertilizers Company Ltd.
- Hindustan Organics Chemicals Ltd.
- Iran Petrochemicals
- Jindal India Thermal Power Ltd.
- Kriloskar Brothers Ltd.
- Kuwait Ministry of Water and Electricity
- MAHAGENCO
- Matix Fertilizers & Chemicals Ltd.
- National Fertilizers Ltd.
- National Thermal Power Corporation Ltd. (NTPC)
- Nuclear Power Corporation of India Ltd. (NPCIL)
- Oil and Natural Gas Company Ltd. (ONGC)
- Projects Development India Ltd.
- Rashtriya Chemical Fertilizers Ltd.
- Reliance Power
- Tata Chemicals
- Tata Power Company Ltd
- Tata Projects Ltd.
- Usher Eco Power Ltd.
- VA-Tech Wabag



**VIBA FLUID CONTROL**

Manufacturers of all Types of Industrial Valves